

PRIMINER

VERTICAL MACHINING CENTERS

PRECISE · DYNAMIC · RELIABLE

Le macchine utensili PRIMINER
sono distribuite in Italia da



Top price/performance ratio

High-quality components

Numerous options

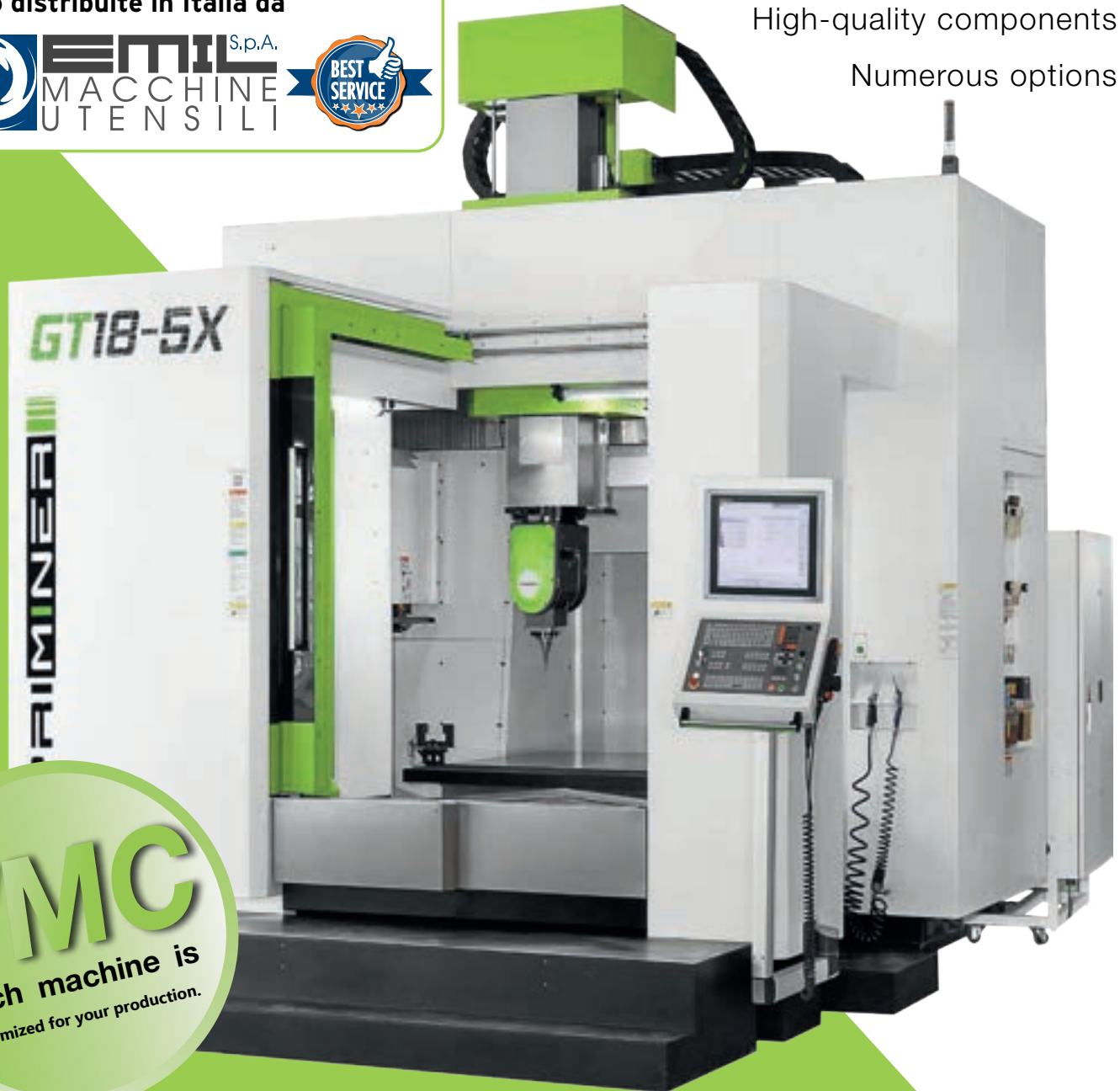

VMC

Each machine is
customized for your production.





PRIMINER

The Company



Jack Chen | CEO Priminer Company Group
Benjamin Kaehlcke | General Manager, Germany



PRIMINEA |||

U500-5X



- Gantry design
- Torque motor direct drive rotary table
- Dual drive system with two ballscrews on Y axis to ensure the best dynamic.
- Compact design with minimum floor plan area

Technical Specifications		U500-5X		
Table				
Max. workpiece diameter	mm	Φ700		
Table size	mm	Φ500		
T-slot (width x number x distance)	mm	14 x 5 x 80		
Max. load	kg	500		
Travel				
X/Y/Z Travel	mm	700 / 650 / 450		
A/C Travel	deg	+30° ~ -110° / 360°		
Spindle				
Spindle taper	-	HSK A63	HSK A63	HSK E50
Spindle motor power	kW	21 / 26	20 / 24	15 / 18
Spindle motor torque	Nm	67 / 86	48 / 58	14 / 17.3
Spindle speed	rpm	18000	20000	36000
Spindle nose to table	mm	135-585	110-560	110-560
Feed				
Rapid feed X/Y/Z	m/min	36		
Rotation speed A/C	rpm	100 / 170		
Cutting speed	mm/min	1-12000		
Tool changer				
Number of tools	pcs	32		
Max. tool length	mm	250		
Max. tool diameter	mm	Φ63		
Max. tool weight	kg	4		
Accuracy(VDI 3441 Full travel)				
Positioning accuracy	mm	0.006 (X/Y/Z) 5/3 arc-sec (A/C)		
Repeatability accuracy	mm	0.003 (X/Y/Z) 2.5/2 arc-sec (A/C)		
Dimensions & Weight				
Dimensions	mm	3560x3380x2995		
Weight	kg	9000		

Standard configuration	
✓ Direct drive rotary table	✓ Centralized automatic grease lubrication system
✓ Full enclosed splash guard	✓ Coolant system
✓ Built-in spindle HSK A63 20000 rpm	✓ 32 pockets tool changer
✓ Chain type chip conveyor	✓ Air blast during cutting
✓ Air-conditioned electrical cabinet	✓ LED working lamp
✓ High precision spindle water cooler	✓ End of program light
✓ Linear scales on X/Y/Z axis	✓ Electronic handwheel (MPG)
✓ Rotary encoder on A/C axis	✓ Tool box
✓ Rigid tapping	✓ Leveling bolts and blocks
✓ Ethernet ,CF card and USB interface	✓ Coolant gun
	✓ Air gun
	✓ User Manual

Optional configuration	
■ Built-in spindle HSK A63 18000 rpm	
■ Built-in spindle HSK E50 36000 rpm	
■ CTS Coolant through spindle + ATS	
■ Oil cooling through ballscrew	
■ Workpiece probe	
■ Tool probe	
■ Dynamic Collision Monitoring (DCM)	
■ Kinematics	
■ Oil mist collector	
■ Minimum Quantity Lubrication system	
■ Coolant Cooling system	
■ Extra 200GB SSD program memory	

Cutting Area

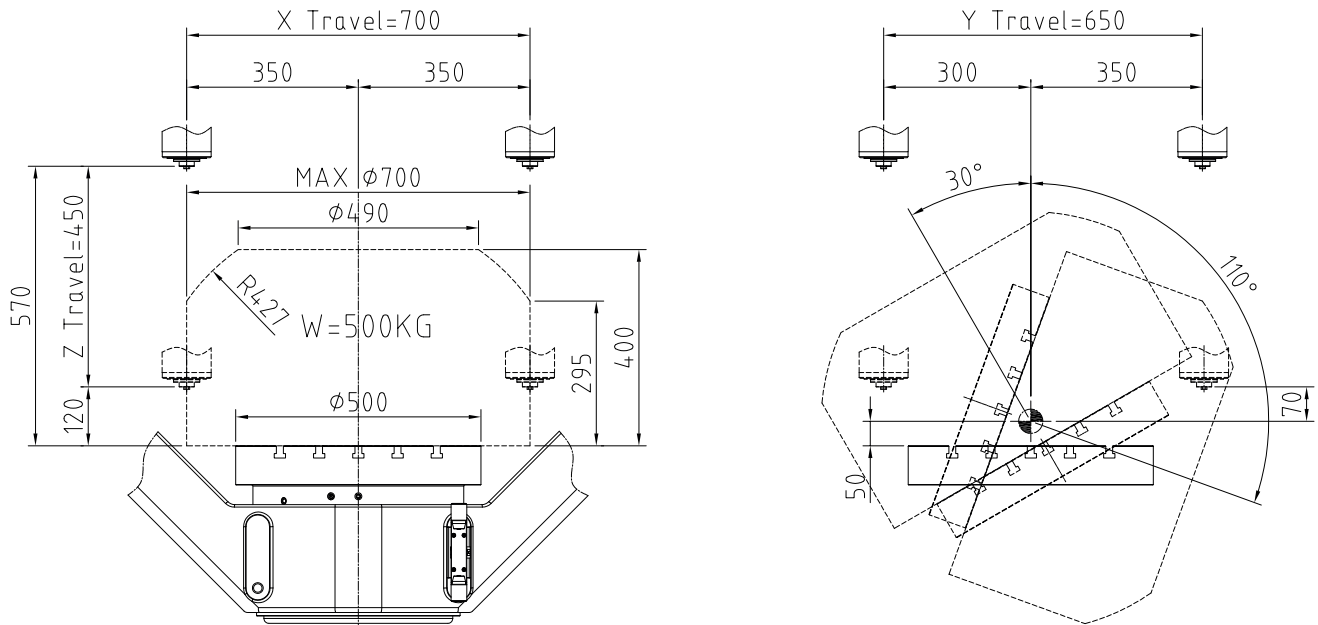

Dimensions

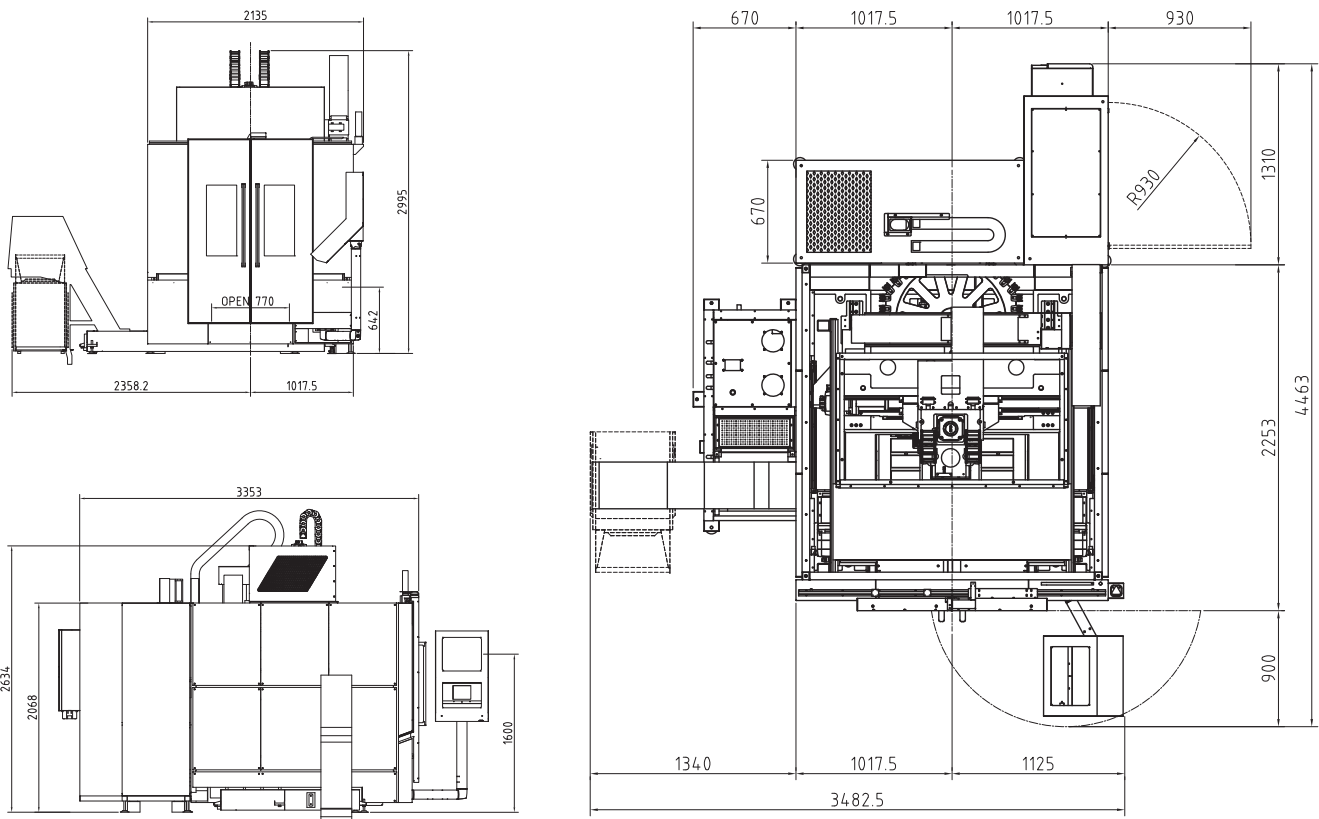

* The above specifications are subject to change without prior notice, no liability for mistakes. Machines may be shown with optional equipment.

C500-5X



- X/Y/Z axis movement are separated from the machining area
- Dual-support rotary table, high rigidity, high performance and efficiency
- A/C axis with roller gear cam drive
- X/Y/Z axis optional with direct measuring system
- A/C axis optional with rotary encoder

Technical Specifications		C500-5X
Table		
Max. workpiece diameter	mm	700
Table size	mm	Φ500 x 400
T-slot (width x number x distance)	mm	14 x80 x5
Max. load	kg	300
Travel		
X/Y/Z Travel	mm	700 / 550 / 500
A/C Travel	deg	+30° ~ -120° / 360°
Spindle nose to table	mm	120 - 620
Spindle		
Spindle taper	-	SK40/BBT40/CAT40
Spindle motor power	kW	33,5
Spindle motor torque	Nm	63 / 135
Spindle speed	rpm	15000
Feed		
Rapid feed X/Y/Z	m/min	48
Rotation speed A/C	rpm	50/60
Cutting speed	mm/min	1-15000
Tool changer		
Number of tools	pcs	40
Max. tool length	mm	300
Max. tool diameter	mm	Φ80 / Φ125
Max. tool weight	kg	8
Accuracy(VDI 3441 Full travel)		
Positioning accuracy (Without linear scales)	mm	0.008 (X/Y/Z)
Repeatability accuracy (Without linear scales)	mm	0.006 (X/Y/Z)
Positioning accuracy (With linear scales)	mm	0.006 (X/Y/Z)
Repeatability accuracy (With linear scales)	mm	0.004 (X/Y/Z)
Dimensions & Weight		
Dimensions	mm	3976x4965x3050
Weight	kg	9000

Standard configuration

- ✓ Roller gear cam drive rotary table
- ✓ Full enclosed splash guard
- ✓ Direct drive spindle 12000rpm
- ✓ 40 pockets chain type tool changer
- ✓ Chain type chip conveyor
- ✓ Spindle oil cooler
- ✓ Air-conditioned electrical cabinet
- ✓ Rigid tapping
- ✓ Ethernet, CF card and USB interface
- ✓ Automatic lubrication system
- ✓ Coolant system
- ✓ Air blast during cutting
- ✓ LED working lamp
- ✓ End of program light
- ✓ Electrical handwheel (MGP)
- ✓ Tool box
- ✓ Leveling bolts and blocks
- ✓ Coolant gun
- ✓ Air gun
- ✓ User manual

Optional configuration

- Direct drive spindle 15000 rpm SK40/BBT40/CAT40, 8.5/33.5 kW_63/135 Nm
- Direct drive spindle 15000 rpm HSK A63, 8.5/33.5 kW, 63/135 Nm
- Built-in spindle 18000rpm HSK A63, 30/36kW_85/102 Nm
- Built-in spindle 20000 rpm HSK A63, 20/24 kW_48/58 Nm
- 60 pockets chain type tool changer
- Linear scales on X/Y/Z axis
- Rotary encoder on A/C axis
- CTS Coolant Through Spindle + ATS
- Workpiece probe
- Tool probe
- Oil mist collector
- Oil skimmer
- Dynamic Collision Monitoring (DCM)
- Kinematics
- Extra 200GB SSD program memory

Cutting Area

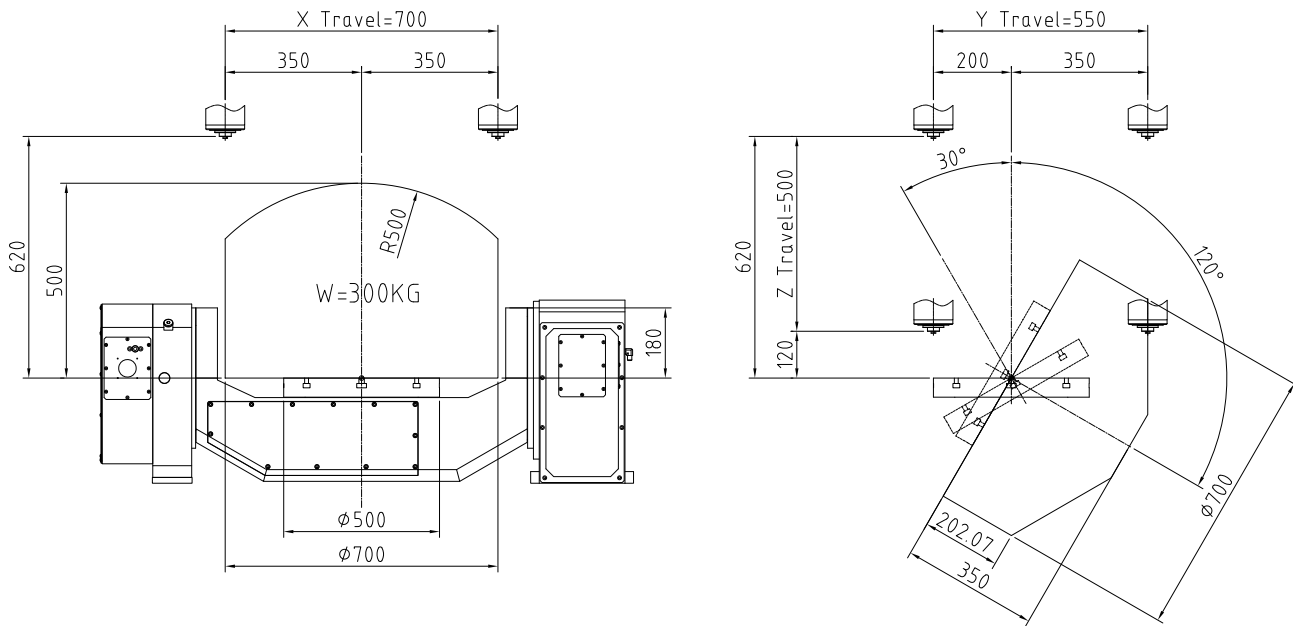

Workpiece samples

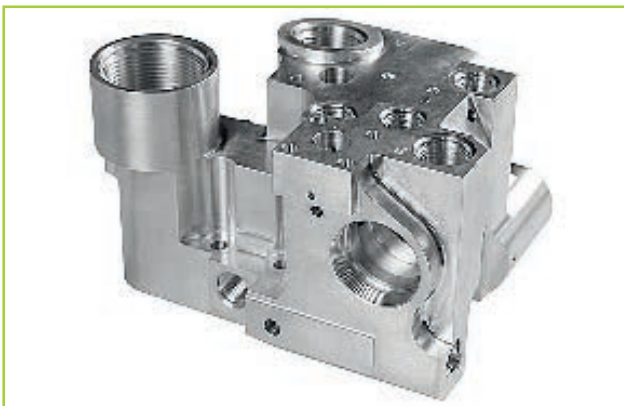

* The above specifications are subject to change without prior notice, no liability for mistakes. Machines may be shown with optional equipment.

5 axis simultaneous machining for XL parts with optimized double column design

GT18-5X · GT320-5X · GT428-5X



Technical Specifications		GT18-5X	GT320-5X	GT428-5X
Table				
Table size	mm	1800 x 1400	3300 x 1700	4000 x 2400
T-slot (width x number x distance)	mm	22 x 7 x 170	22 x 9 x 170	28 x 11 x 200
Max. load	kg	6000	10000	12000
A(B)/C Axis	-	±108° / ±270°		±115° / ±360°
Travel				
X/Y/Z Travel	mm	1900/1400/800	3300/2700/1000	4200/3300/1200
Spindle nose to table	mm	100 - 900	100 - 1100	200-1400
90°spindle center line to table	mm	410-1210	410-1410	460-1660
Distance between columns	mm	1960	2000	2800
Spindle				
Spindle taper	-	HSK A63		HSK A100
Motor power	kW	42/56.7		50/61
Motor torque	Nm	68/90.2		160/193
Spindle speed	rpm	24000		12000
Feed				
Rapid feed X/Y/Z	m/min	30	24/24/30	20
Cutting speed	mm/min	1-12000		
A(B)/C Max. speed	rpm	50		
Tool changer				
Number of tools	pcs	60		
Max. tool length	mm	300		400
Max. tool diameter	mm	Φ78 / Φ150		Φ125 / Φ250
Max. tool weight	kg	8		16
Accuracy(VDI 3441 Full travel)				
Positioning accuracy	mm	0.010/0.010/0.008(X/Y/Z) 6/8 arc-sec(B/C)	0.015/0.015/0.010(X/Y/Z) 6/8 arc-sec(A/C)	0.020/0.015/0.010(X/Y/Z) 6/8 arc-sec(A/C)
Repeatability accuracy	mm	0.006(X/Y/Z) 3/4 arc-sec(B/C)	0.010/0.010/0.006(X/Y/Z) 3/4 arc-sec(A/C)	0.015/0.010/0.006(X/Y/Z) 3/4 arc-sec(A/C)
Dimensions & Weight				
Dimensions	mm	6160x4970x4840	10000x5700x5800	10500x6200x6250
Weight	kg	24000	30000	52000

Standard configuration:

- ✓ Full enclosed splash guard
- ✓ Chip conveyor (two screw type and one chain type)
- ✓ Air-conditioned electrical cabinet
- ✓ High precision spindle water cooler
- ✓ Linear scales on X/Y/Z axis
- ✓ Rigid tapping
- ✓ Ethernet, CF card and USB interface
- ✓ Automatic lubrication system
- ✓ Coolant system
- ✓ Air blast during cutting
- ✓ LED working lamp
- ✓ End of program light
- ✓ Electronic handwheel (MPG)
- ✓ Tool box
- ✓ Leveling bolts and blocks
- ✓ Coolant gun
- ✓ Air gun
- ✓ User Manual

Optional configuration:

- Built-in spindle HSK A100 15000 rpm_40/50kW_103/129Nm, 40 pockets tool changer(GT18-5X/GT320-5X)
- Built-in spindle HSK A100 12000 rpm_40/47kW_248/293Nm(GT428-5X)
- CTS Coolant through spindle + ATS
- Oil cooling through ballscrew(only available on GT18-5X)
- Oil skimmer
- Minimum Quantity Lubrication system(only available on GT18-5X)
- Coolant Cooling system
- Workpiece probe
- Tool probe
- Dynamic Collision Monitoring(DCM)
- Kinematics



- High speed and high precision machining, widely applied for big die & mold, electronics, defense, aerospace and medical industry
- Dual drive on Y axis to ensure the best dynamic performance(GT18-5X)
- DD Driven Double arm A(B),C head
- Standard with Direct measuring system for X, Y, Z axis

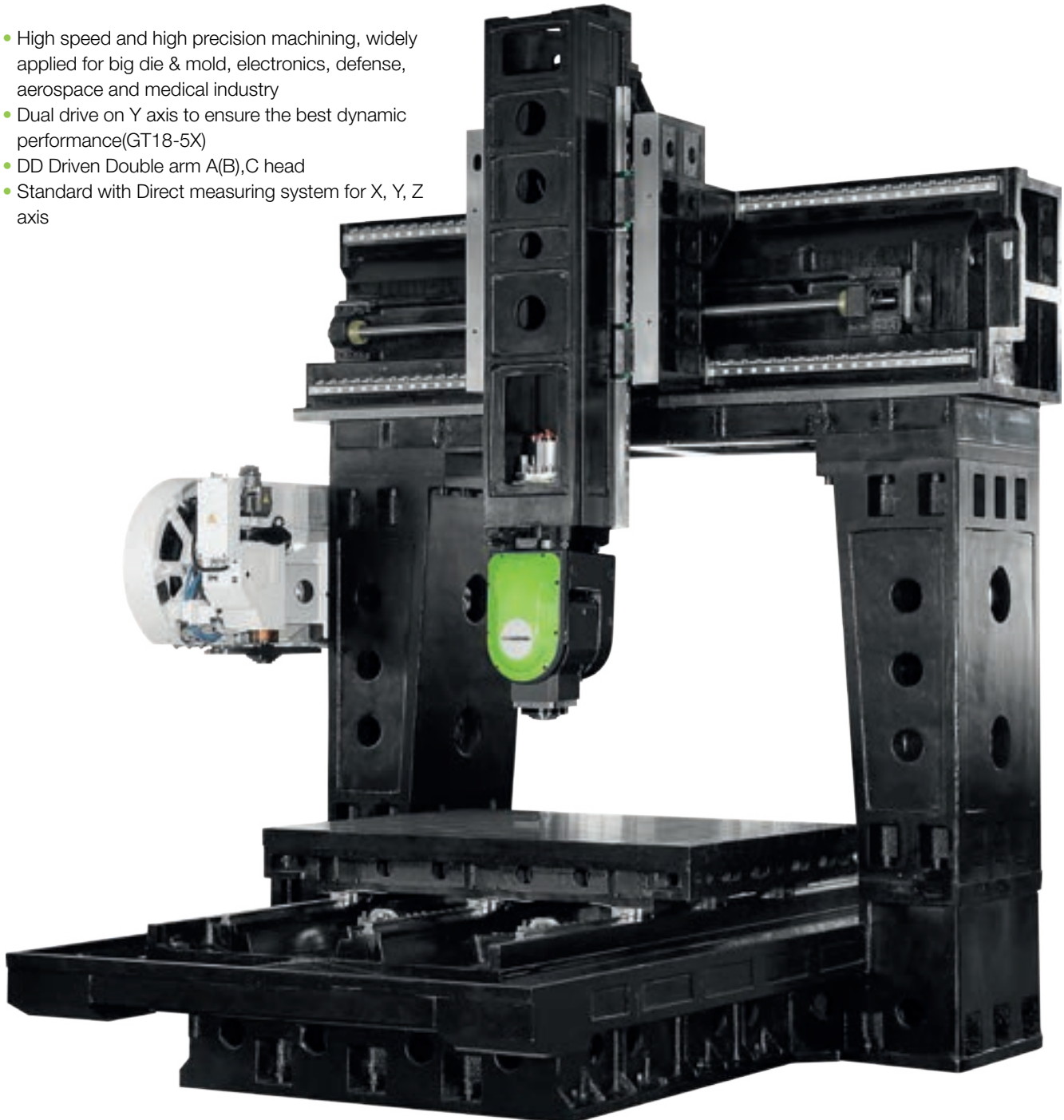

* The above specifications are subject to change without prior notice, no liability for mistakes. Machines may be shown with optional equipment.

GT7

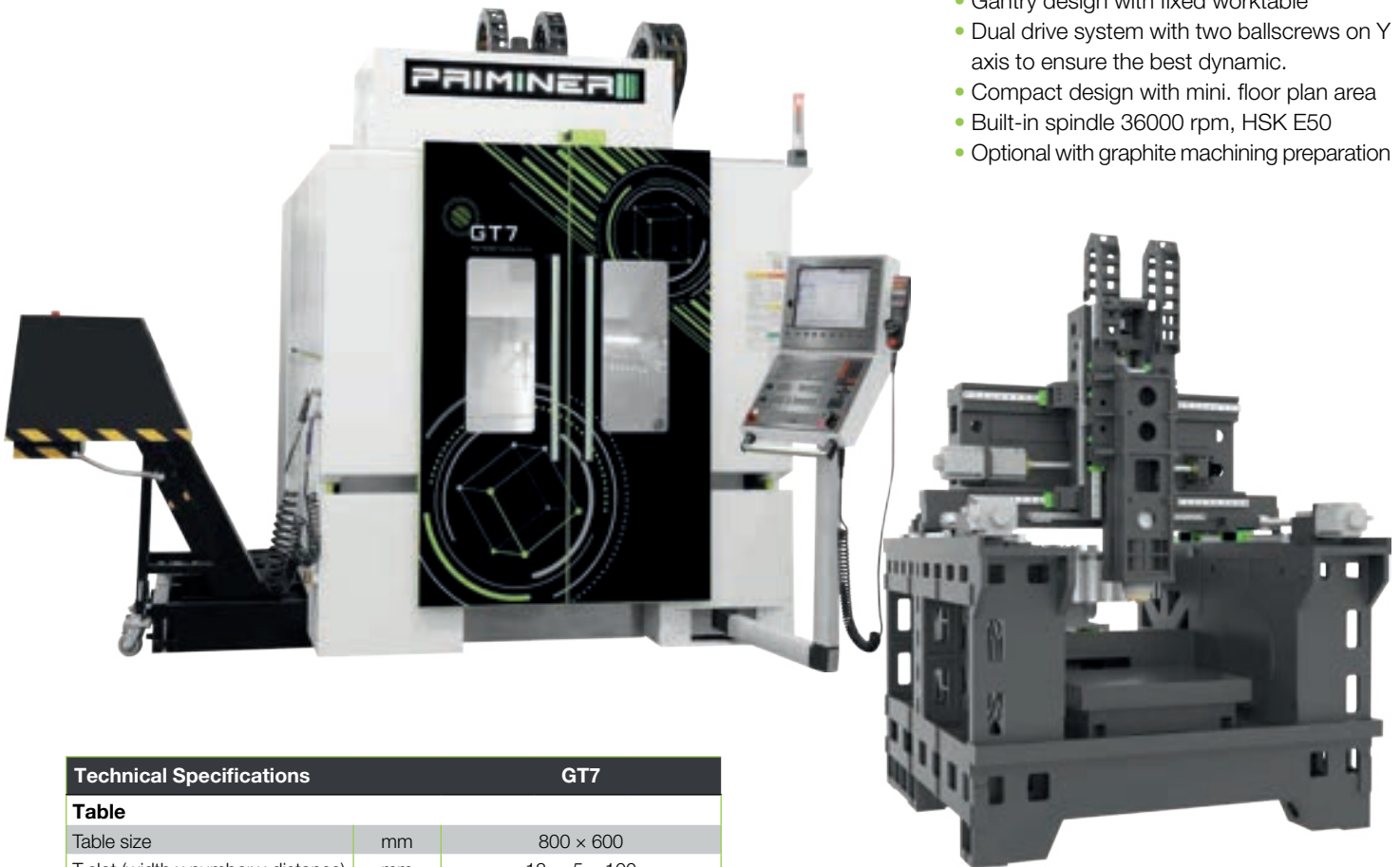

- Best Choice for high speed cutting
- Gantry design with fixed worktable
- Dual drive system with two ballscrews on Y axis to ensure the best dynamic.
- Compact design with mini. floor plan area
- Built-in spindle 36000 rpm, HSK E50
- Optional with graphite machining preparation

Technical Specifications		GT7		
Table				
Table size	mm	800 × 600		
T-slot (width x number x distance)	mm	18 × 5 × 100		
Max. load	kg	600		
Travel				
X/Y/Z Travel	mm	700 / 600 / 450		
Distance between columns	mm	-		
Spindle				
Spindle taper	-	HSK A63	HSK E50	HSK E32
Spindle motor power	kW	20 / 24	15 / 18	6.3 / 9.45
Spindle motor torque	Nm	35 / 42	14 / 17.3	2 / 3
Spindle speed	rpm	20000	36000	40000
Spindle nose to table	mm	135-585	135-585	145-595
Feed				
Rapid feed X/Y/Z	m/min	15		
Cutting speed	mm/min	1-12000		
Tool changer				
Number of tools	pcs	32		
Max. tool length	mm	250		
Max. tool diameter	mm	63		
Max. tool weight	kg	4		
Accuracy (VDI 3441 Full travel)				
Positioning accuracy	mm	0.006		
Repeatability accuracy	mm	0.003		
Dimensions & Weight				
Dimensions	mm	3560×3380×2995		
Weight	kg	8000		

Standard configuration:

- ✓ Full enclosed splash guard
- ✓ Built-in motor spindle HSK E50 36000 rpm
- ✓ 32 pockets tool changer
- ✓ Air-conditioned electrical cabinet
- ✓ High precision spindle water cooler
- ✓ Linear scales on X/Y/Z
- ✓ Rigid tapping
- ✓ Ethernet, CF card and USB interface
- ✓ Centralized automatic grease lubrication system
- ✓ Coolant system
- ✓ Air blast during cutting
- ✓ LED working lamp
- ✓ End of program light
- ✓ Electronic handwheel (MPG)
- ✓ Tool box
- ✓ Leveling bolts and blocks
- ✓ Coolant gun
- ✓ Air gun
- ✓ User Manual

Optional configuration:

- Built-in motor spindle HSK A63 20000rpm, 32 pockets tool changer
- Built-in motor spindle HSK E32 40000rpm, 48 pockets tool changer
- Chain type chip conveyor
- Graphite Machining Preparation
- Oil mist collector
- Oil cooling through ballscrew
- CTS Coolant through spindle + ATS
- Oil skimmer
- Minimum Quantity Lubrication system
- Coolant Cooling system
- Workpiece probe
- Tool probe

Worktable

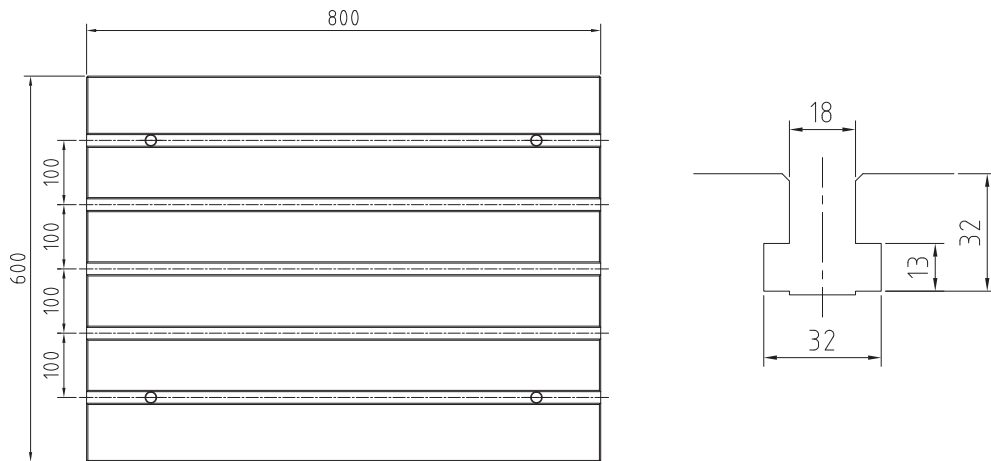

Dimensions

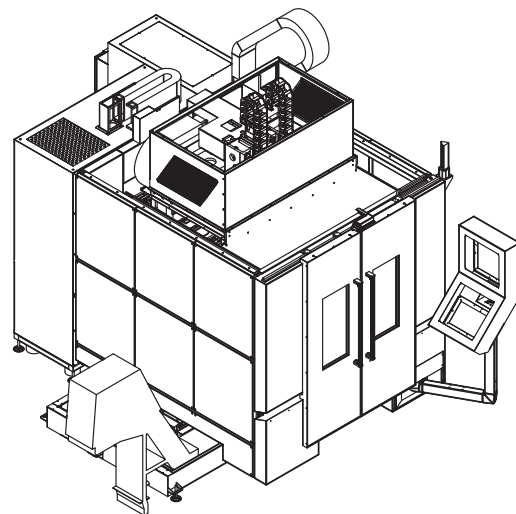
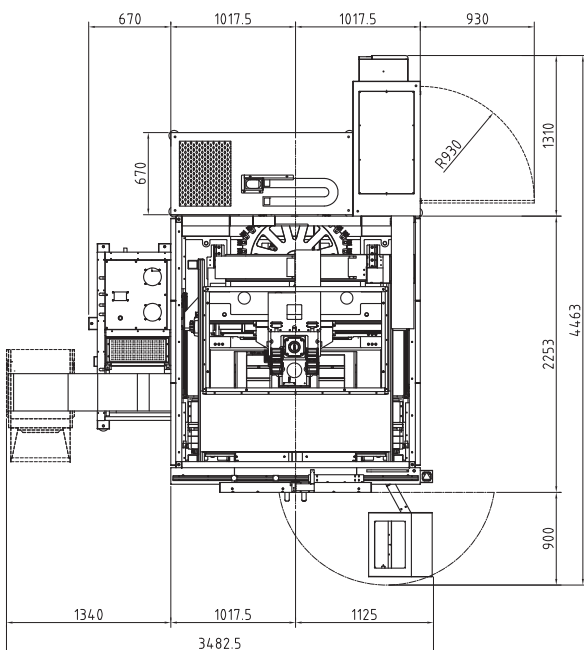
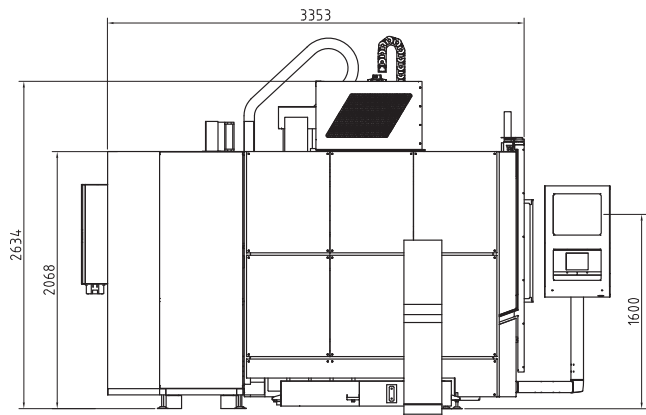
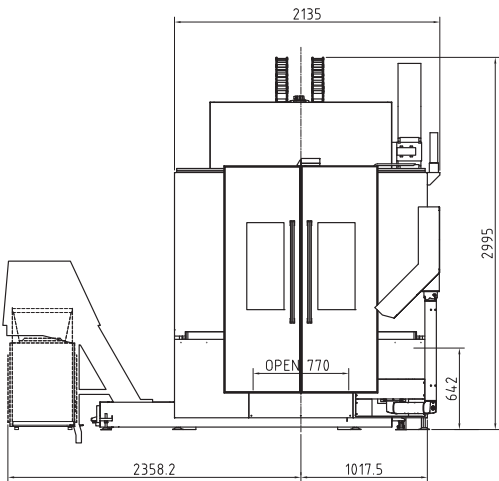

* The above specifications are subject to change without prior notice, no liability for mistakes. Machines may be shown with optional equipment.

GT11



Technical Specifications		GT11
Table		
Table size	mm	1200x700
T-slot (width x number x distance)	mm	18x6x100
Max. load	kg	1500
Travel		
X/Y/Z Travel	mm	1150 / 700 / 520
Spindle nose to table	mm	140-660
Spindle		
Spindle taper		HSK A63
Motor power	kW	25/28
Motor torque	Nm	87/96
Spindle speed	rpg	20000
Feed		
Rapid feed X/Y/Z	m/min	24
Cutting speed	mm/min	1-12000
Tool changer		
Number of tools	pcs	40
Max. tool length	mm	300
Max. tool diameter	mm	Φ78 / Φ125
Max. tool weight	kg	8
Accuracy (VDI3441 Full travel)		
Positioning accuracy	mm	0.006
Repeatability accuracy	mm	0.003
Dimensions & Weight		
Dimensions	mm	3680x3180x3090
Weigth	kg	9000

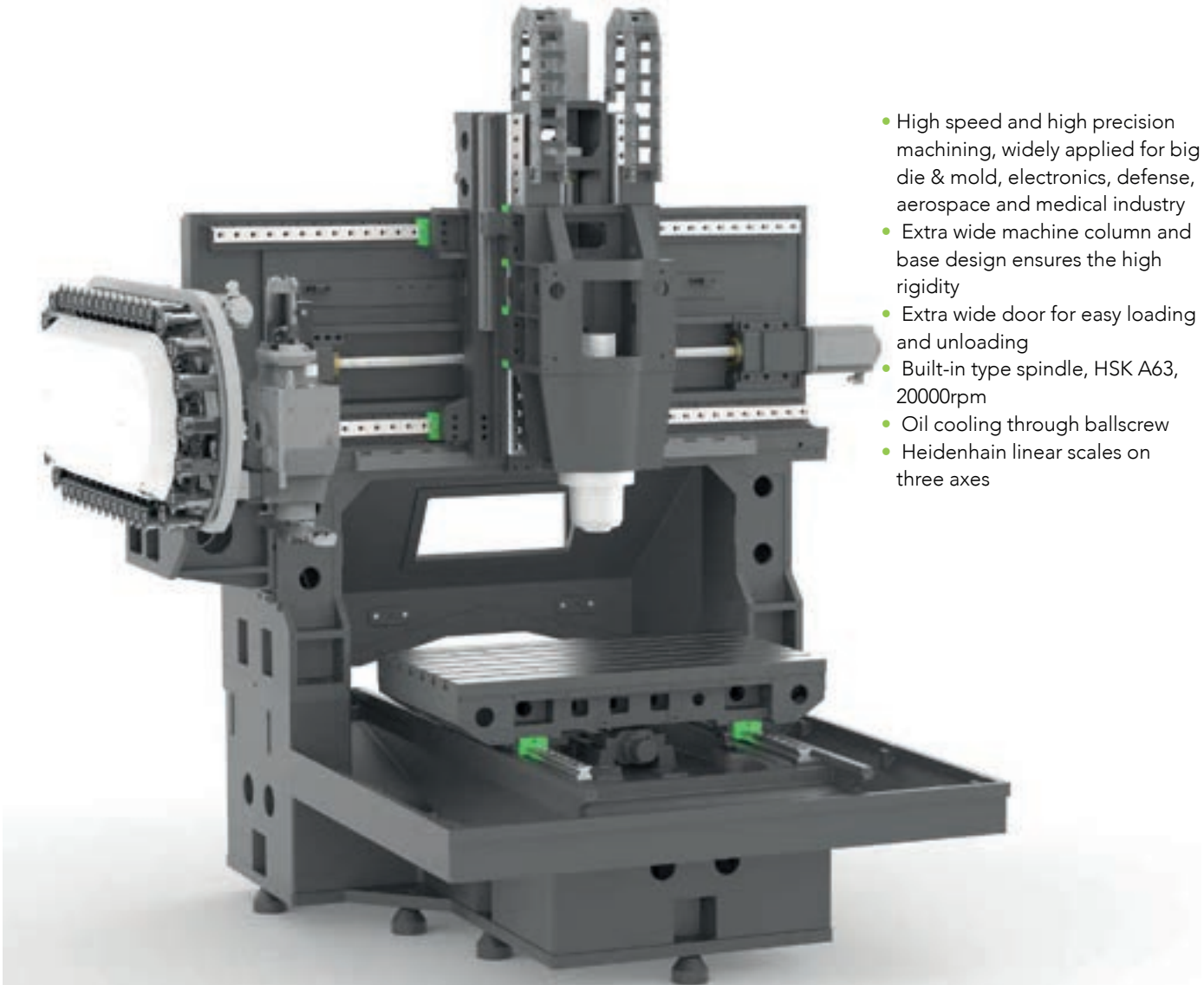

- High speed and high precision machining, widely applied for big die & mold, electronics, defense, aerospace and medical industry
- Extra wide machine column and base design ensures the high rigidity
- Extra wide door for easy loading and unloading
- Built-in type spindle, HSK A63, 20000rpm
- Oil cooling through ballscrew
- Heidenhain linear scales on three axes



Standard configuration:

- ✓ Full enclosed splash guard
- ✓ Built-in spindle HSK A63 20000 rpm
- ✓ 40 pockets chain type tool changer
- ✓ Air-conditioned electrical cabinet
- ✓ High precision spindle water cooler
- ✓ Linear scales on X/Y/Z
- ✓ Rigid tapping
- ✓ Ethernet, CF card and USB interface
- ✓ Automatic lubrication system
- ✓ Coolant system
- ✓ Air blast during cutting
- ✓ LED working lamp
- ✓ End of program light
- ✓ Electronic handwheel (MPG)
- ✓ Tool box
- ✓ Leveling bolts and blocks
- ✓ Coolant gun
- ✓ Air gun
- ✓ User Manual

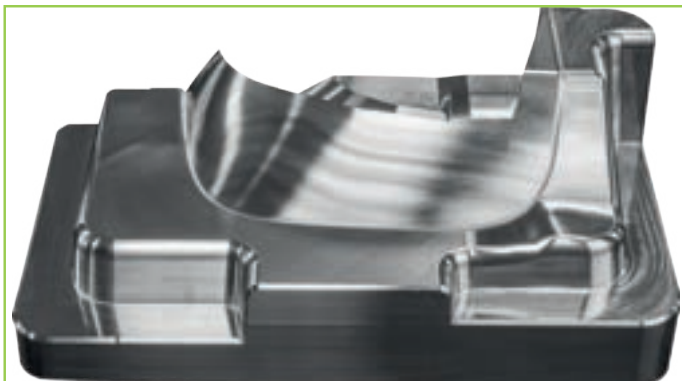

Optional configuration:

- Automatic Chip Removal System
- Three screw type plus one chain type chip conveyor
- CTS Coolant through spindle + ATS
- Oil cooling through ballscrew
- Oil skimmer
- Oil mist collector
- Workpiece probe
- Tool probe

* The above specifications are subject to change without prior notice, no liability for mistakes. Machines may be shown with optional equipment.

GT18



Technical Specifications		GT18
Table		
Table size	mm	1800×1400
T-slot (width x number x distance)	mm	22×7×170
Max. load	kg	6000
Travel		
X/Y/Z Travel	mm	1800 / 1400 / 800
Spindle nose to table	mm	150-950
Spindle center to column	mm	400
Distance between columns	mm	1960
Spindle		
Spindle taper		HSK A63
Motor power	kW	21 / 27
Motor torque	Nm	85 / 116
Spindle speed	rpg	24000
Feed		
Rapid feed X/Y/Z	m/min	30
Cutting speed	mm/min	1-12000
Tool changer		
Number of tools	pcs	60
Max. tool length	mm	300
Max. tool diameter	mm	Φ78 / Φ150
Max. tool weight	kg	8
Accuracy (VDI3441 Full travel)		
Positioning accuracy	mm	0.010/0.010/0.008(X/Y/Z)
Repeatability accuracy	mm	0.006(X/Y/Z)
Dimensions & Weight		
Dimensions	mm	6100×4965×4380
Weighth	kg	22000

- High speed and high precision machining, widely applied for big die & mold, electronics, defense, aerospace and medical industry
- Extra wide machine column and base design ensures the high rigidity
- Dual drive system with two ballscrews and three linear guideways on Y axis to ensure high accuracy of machining
- Extra wide door for easy loading and unloading
- Built-in type spindle, HSK A63, 24000rpm
- Oil cooling through ballscrew
- Heidenhain linear scales on three axes
- 60 pockets chain type servo tool changer

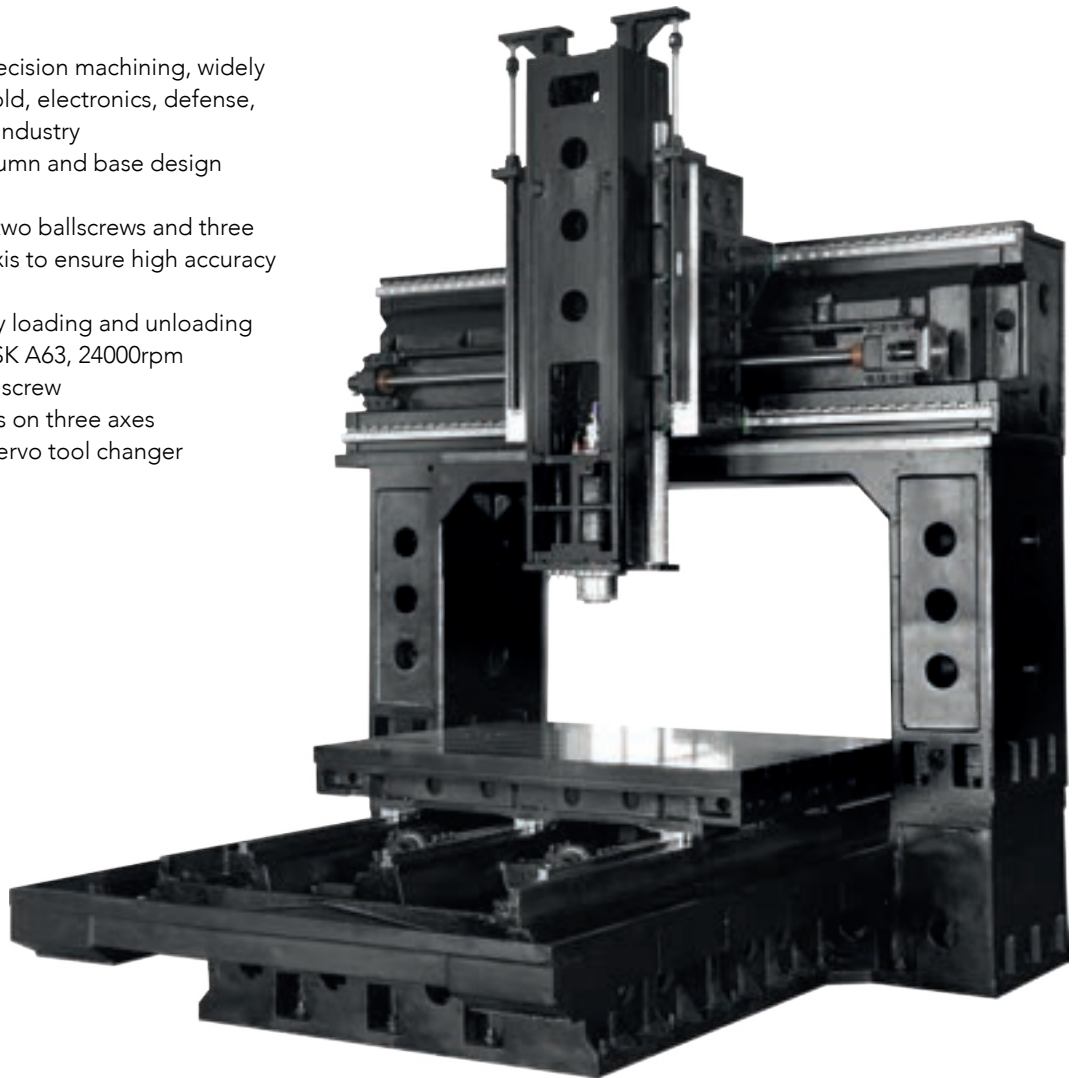

Standard configuration:

- ✓ Full enclosed splash guard
- ✓ Built-in spindle HSK A63 24000 rpm
- ✓ 60 pockets chain type servo tool changer
- ✓ Chip conveyor(two screw type and one chain type)
- ✓ Air-conditioned electrical cabinet
- ✓ High precision spindle water cooler
- ✓ Linear scales on X/Y/Z
- ✓ Oil-air lubrication system for spindle
- ✓ Rigid tapping
- ✓ Ethernet, CF card and USB interface
- ✓ Automatic lubrication system
- ✓ Coolant system
- ✓ Air blast during cutting
- ✓ LED working lamp
- ✓ End of program light
- ✓ Electronic handwheel (MPG)
- ✓ Tool box
- ✓ Leveling bolts and blocks
- ✓ Coolant gun
- ✓ Air gun
- ✓ User Manual

Optional configuration:

- Built-in spindle HSK A100 12000 rpm
- CTS Coolant through spindle + ATS
- Oil cooling through ballscrew
- Oil skimmer
- Oil mist collector
- Spindle oil cooler
- Workpiece probe
- Tool probe

* The above specifications are subject to change without prior notice, no liability for mistakes. Machines may be shown with optional equipment.

UHP Center VF900 · 1100 · 1300 · 1500



- VF series ultra high performance center is specially designed for high speed and high efficiency machining applications
- Advanced design with reinforced body structure through FEM analysis. VF series offers superb cutting performance and reduced vibration to meet the highest machining demands
- Extra wide machine column and base design ensures the high rigidity during high speed movement
- Motor seat cooling circuit (VF1100 & VF1300)
- Oil cooling through ballscrew(Only available on VF1100)
- Linear scales (option)

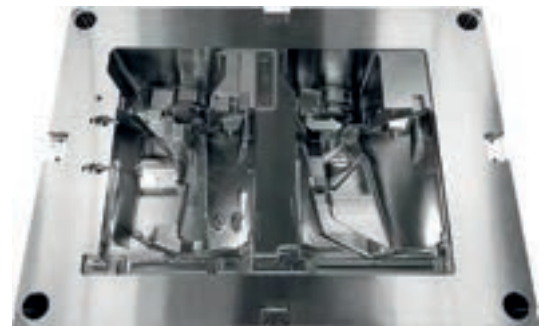

Standard configuration:

- ✓ Fully enclosed splash guard
- ✓ Direct drive spindle 12000 rpm (VF900)
- ✓ Direct drive spindle 15000 rpm (VF1100, VF1300, VF1500)
- ✓ 24 pockets arm tool changer
- ✓ Two screw type and one chain type (VF 1100, VF1300)
- ✓ Chain type chip conveyor (VF900, VF1500)
- ✓ Spindle oil cooler
- ✓ Air-conditioned electrical cabinet
- ✓ Motor seat cooling circuit (VF1100, VF1300, VF1500)
- ✓ Rigid tapping
- ✓ Ethernet, CF card and USB interface
- ✓ Automatic lubrication system
- ✓ Coolant system
- ✓ LED working lamp
- ✓ End of program light
- ✓ Electronic handwheel (MPG)
- ✓ Tool box
- ✓ Leveling bolts and blocks
- ✓ Coolant gun
- ✓ Air gun
- ✓ Air blast during cutting
- ✓ User Manual

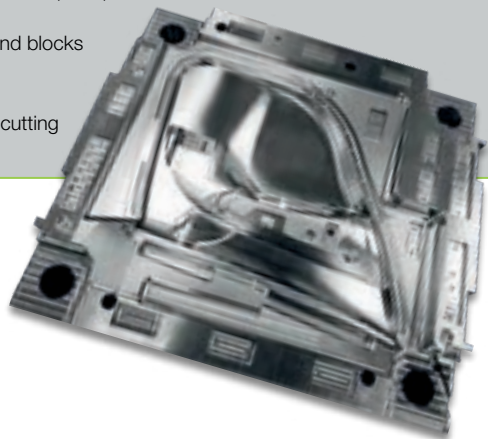

Optional configuration:

- Built-in motor spindle HSK A63 20000rpm
- CTS coolant through spindle + ATS
- Oil cooling through ballscrew(Only available on VF1100)
- Oil skimmer
- Linear scales on X/Y/Z
- 4th axis
- 4/5th axis
- Workpiece probe
- Tool probe

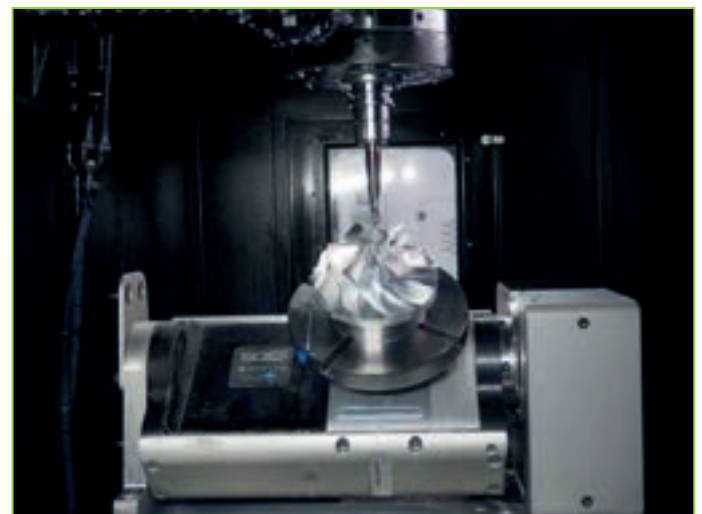

Lehmann 4th & 5th axis

Technical Specification

Technical Specifications		VF900	VF1100	VF1300	VF1500
Table					
Table size	mm	1060 x 600	1300 x 600	1500 x 650	1700 x 700
T-slot (width x number x distance)	mm	18 x 5 x 100		18 x 6 x 100	
Max. load	kg	800	1000	1200	1500
Travel					
X/Y/Z Travel	mm	900 / 600 / 600	1100 / 650 / 600	1300 / 650 / 600	1500/760/700
Spindle nose to table	mm	150 - 750		130 - 830	
Spindle center to column	mm	652	697		802
Spindle					
Spindle taper	-	SK40 / BBT40 / CAT 40			
Spindle motor power/torque	-	9/22kW; 63/135Nm(SIEMENS) 11/18.5kW; 52.5/118Nm(FANUC)		20/53kW; 126/250Nm(SIEMENS) 15/30kW; 95.5/191Nm(FANUC)	
Spindle speed	rpm	12000		15000 Siemens, 12000 Fanuc	
Spindle(option 1)	-	HSK A63, 20000rpm			
Motor power/torque	-	20/24kW; 35/42Nm			
Spindle(option 2)	-	/		HSK A63, 20000rpm	
Motor power/torque	-	/		25/28kW; 87/96Nm	
Feed					
Rapid feed X/Y/Z	m/min	36			24
Cutting feed	mm/min	1 - 12000			
Tool changer					
Number of tools	pcs	24			
Max. tool length	mm	300			
Max. tool diameter	mm	Φ78 / Φ125			
Max. tool weight	kg	8			
Accuracy (VDI 3441 Full travel)					
Positioning accuracy (without linear scales)	mm	0.008		0.010	
Positioning repeatability (without linear scales)	mm	0.006		0.006	
Positioning accuracy (with linear scales)	mm	0.006		0.008	
Positioning repeatability (with linear scales)	mm	0.004		0.006	
Dimensions & Weight					
Dimensions	mm	3850x2340x3000	3850x3100x3185	4025x3090x3185	5180x2365x3170
Weight	kg	6500	7500	8000	10000



Cooling unit with chip conveyor



Keyarrow telescopic covers in all axes

* The above specifications are subject to change without prior notice, no liability for mistakes. Machines may be shown with optional equipment.

Ultra High Performance for powerful and precise machining

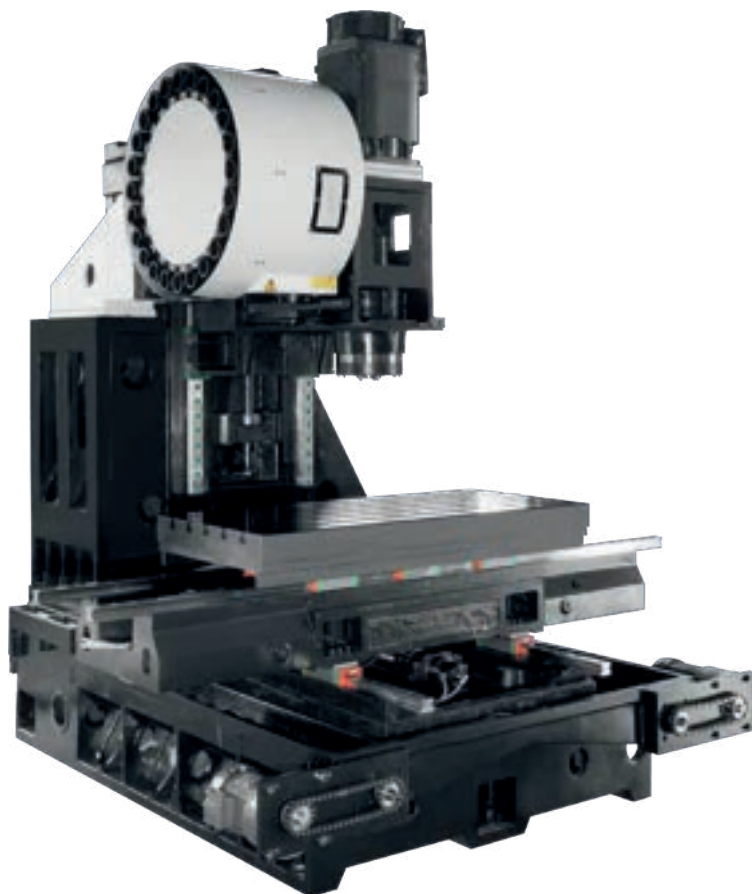

Cast iron tempered for stress relief to ensure structural stability without deformation



Two screw type chip conveyors in Y-axis (VF1100 & VF1300)



External tool cooling



High rigidity spindle



Oil cooling through ballscrew(Only available on VF1100)

Worktable (VF1100)

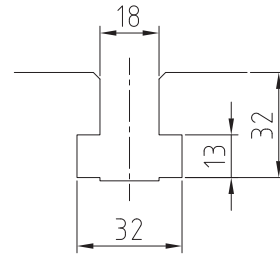
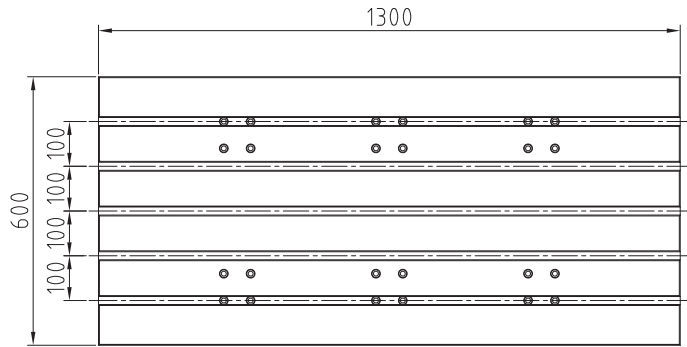

Dimensions (VF1100)

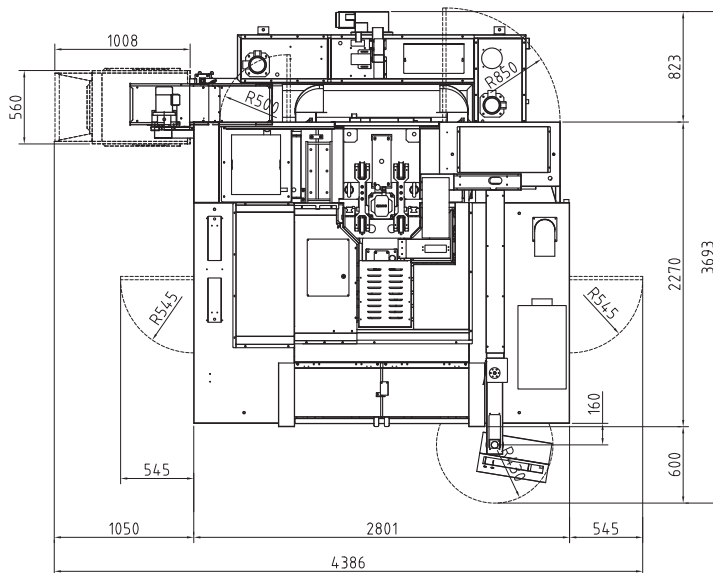
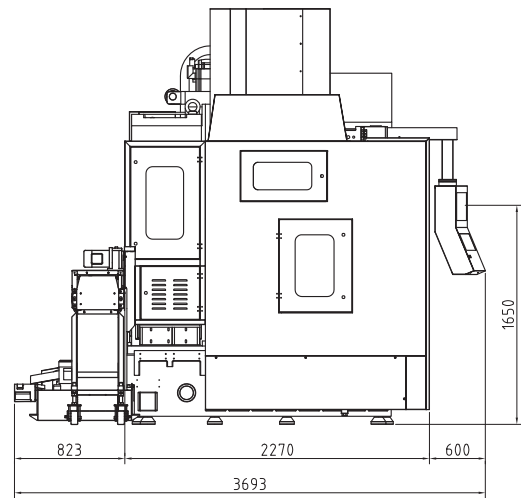
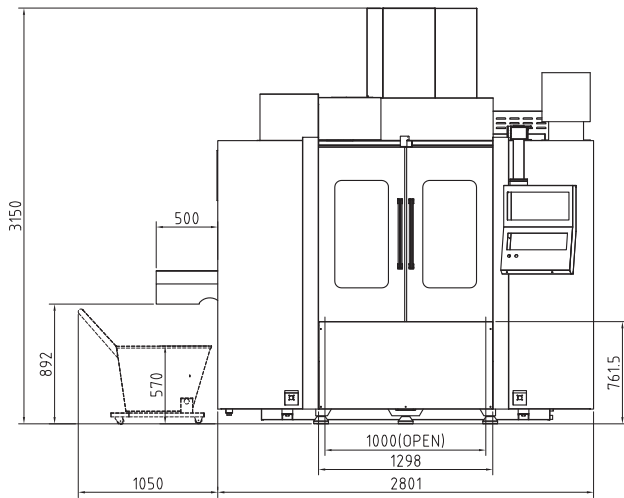

* The above specifications are subject to change without prior notice, no liability for mistakes. Machines may be shown with optional equipment.

Alpha Center V7L



Technical Specifications		Alpha Center V7L
Table		
Table size	mm	900 x 420
T-slot (width x number x distance)	mm	14 x 3 x 125
Max. load	kg	500
Travel		
X/Y/Z Travel	mm	760 / 450 / 520
Spindle nose to table	mm	100 - 620
Spindle center to column	mm	517
Spindle		
Spindle taper	-	SK 40 / BT 40 / CAT 40
Spindle speed	rpm	10000
Spindle motor power/torque	-	9/22kW; 63/135Nm(SIEMENS) 7.5/15kW; 35.8/95.5Nm(FANUC)
Feed		
Rapid feed X/Y/Z	m/min	48
Cutting speed	mm/min	1-12000
Tool changer		
Number of tools	pcs	24
Max. tool length	mm	300
Max. tool diameter	mm	Φ78 / Φ125
Max. tool weight	kg	8
Accuracy (VDI 3441 Full travel)		
Positioning accuracy	mm	0.008
Positioning repeatability	mm	0.006
Dimensions & Weight		
Dimensions	mm	3250x2710x2900
Weight	kg	4500

Standard configuration:

- ✓ Fully enclosed splash guard
- ✓ Belt drive spindle 10000 rpm
- ✓ 24 pockets arm tool changer
- ✓ Chain type chip conveyor
- ✓ Air-conditioned electrical cabinet
- ✓ Rigid tapping
- ✓ Ethernet CF card and USB interface
- ✓ Automatic lubrication system
- ✓ Coolant system
- ✓ LED working lamp
- ✓ End of program light
- ✓ Electronic handwheel (MPG)
- ✓ Tool box
- ✓ Leveling bolts and blocks
- ✓ Coolant gun
- ✓ Air gun
- ✓ Chip flushing system
- ✓ User Manual

Optional configuration:

- Direct drive spindle 12000 rpm
- Spindle oil cooler
- CTS Coolant through spindle + ATS
- Oil skimmer
- Workpiece probe
- Tool probe
- 4th axis
- 4/5th axis

Worktable

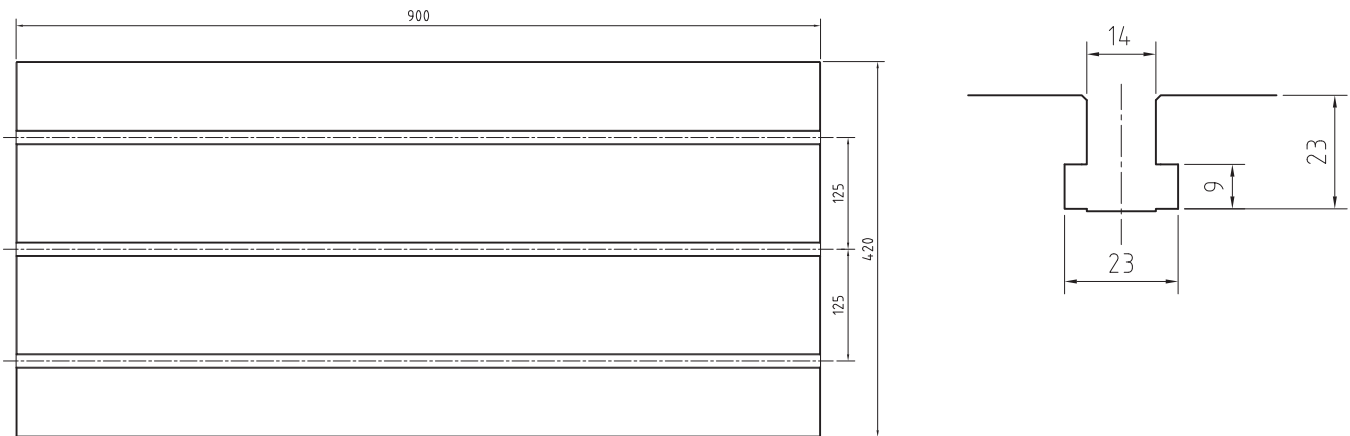

Dimensions

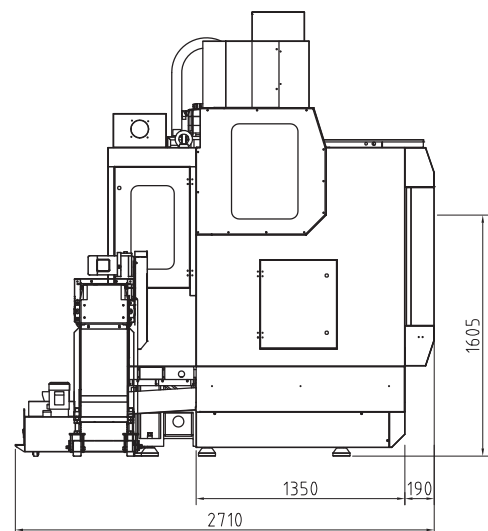
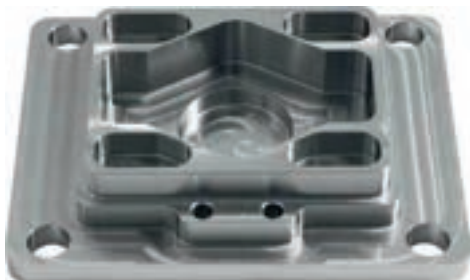
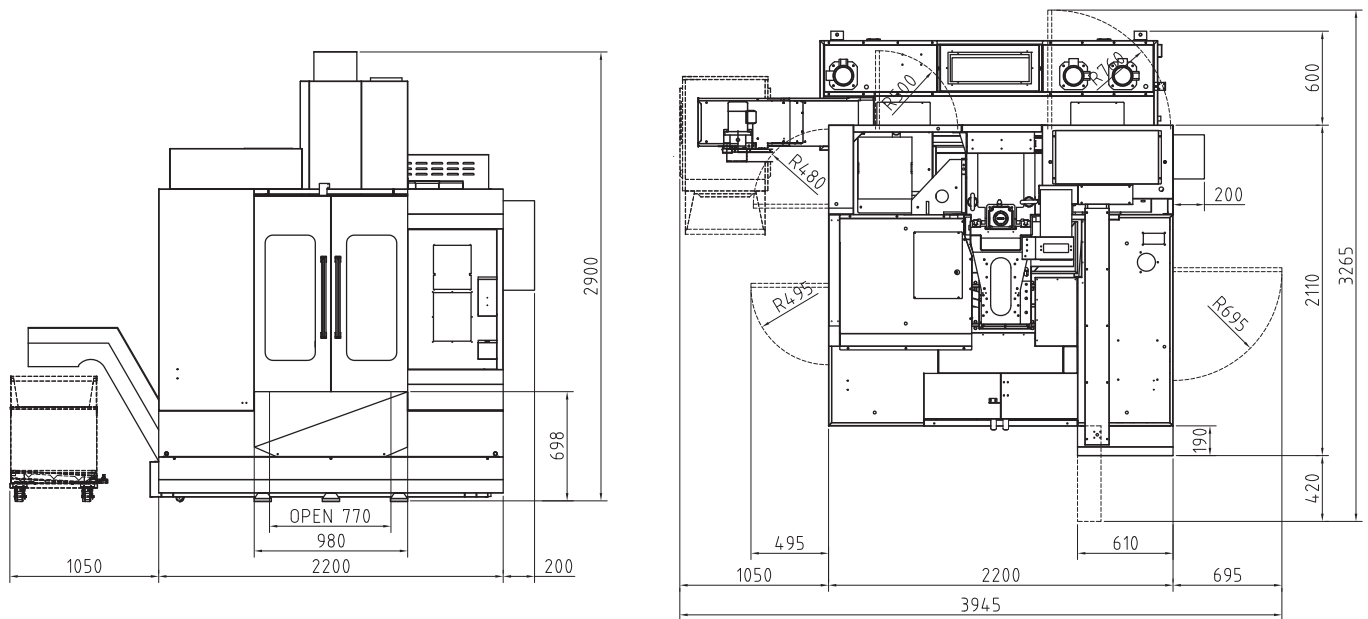

* The above specifications are subject to change without prior notice, no liability for mistakes. Machines may be shown with optional equipment.

Alpha Center V9L · V11L

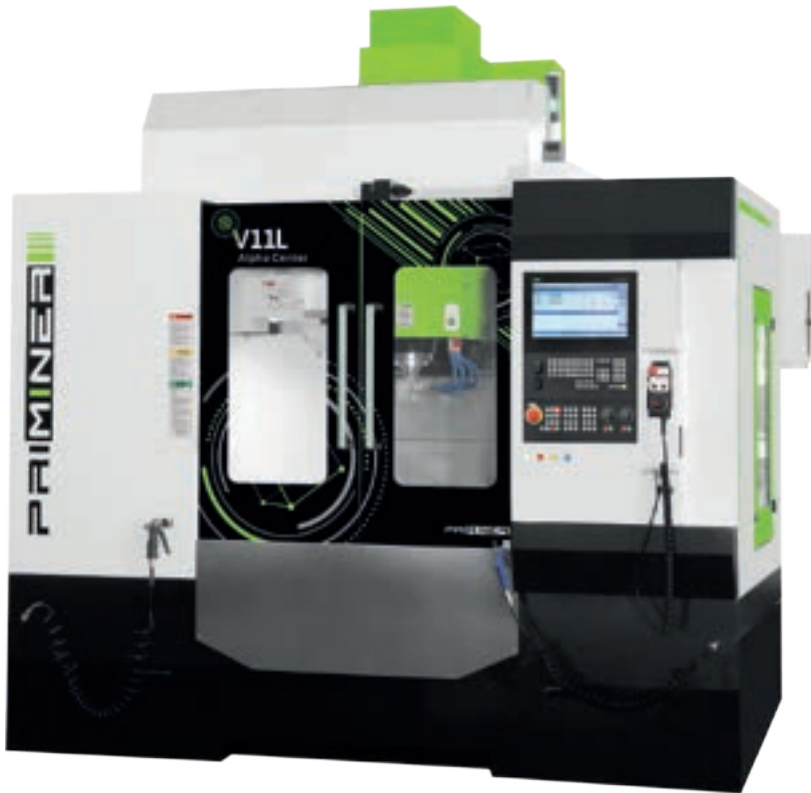

- Cast iron is tempered for stress relief to ensure structural stability without deformation
- C3 class ballscrews ensures the highest accuracy and durability
- Pre-tension on all axis minimizes thermal distortion



Technical Specifications		V9L	V11L
Table			
Table size	mm	1060 x 600	1200 x 600
T-slots (width x number x distance)	mm	18 x 5 x 100	
Max. load	kg	800	1000
Travel			
X/Y/Z Travel	mm	900 / 600 / 600	1100 / 600 / 600
Spindle nose to table	mm	150 - 750	
Spindle center to column	mm	652	
Spindle			
Spindle taper	-	SK 40 / BT 40 / CAT 40	
Spindle motor power/torque	-	9/22kW; 63/135Nm(SIEMENS) 11/18.5kW; 52.5/118Nm(FANUC)	
Spindle speed	rpm	10000	
Feed			
Rapid feed X/Y/Z	m/min	36	
Cutting speed	mm/min	1-12000	
Tool changer			
Number of tools	pcs	24	
Max. tool length	mm	300	
Max. tool diameter	mm	Φ78 / Φ125	
Max. weight	kg	8	
Accuracy (VDI 3441 Full travel)			
Positioning accuracy	mm	0.008	
Positioning repeatability	mm	0.006	
Dimensions & Weight			
Dimensions	mm	3845x2320x3120	
Weight	kg	6300	6500

Standard configuration:

- ✓ Fully enclosed splash guard
- ✓ Belt drive spindle 10000 rpm
- ✓ 24 pockets arm tool changer
- ✓ Chain type chip conveyor
- ✓ Air-conditioned for electrical cabinet
- ✓ Rigid tapping
- ✓ Ethernet, CF card and USB interface
- ✓ Automatic lubrication system
- ✓ Coolant system
- ✓ LED working lamp
- ✓ End of program light
- ✓ Electronic handwheel (MPG)
- ✓ Tool box
- ✓ Leveling bolts and blocks
- ✓ Coolant gun
- ✓ Air gun
- ✓ Chip flushing system
- ✓ User Manual

Optional configuration:

- Direct drive spindle 12000 rpm
- Direct drive spindle 15000 rpm
- Spindle oil cooler
- CTS Coolant through spindle + ATS
- Oil skimmer
- Workpiece probe
- Tool probe
- 4th axis
- 4/5th axis

Worktable (V11L)

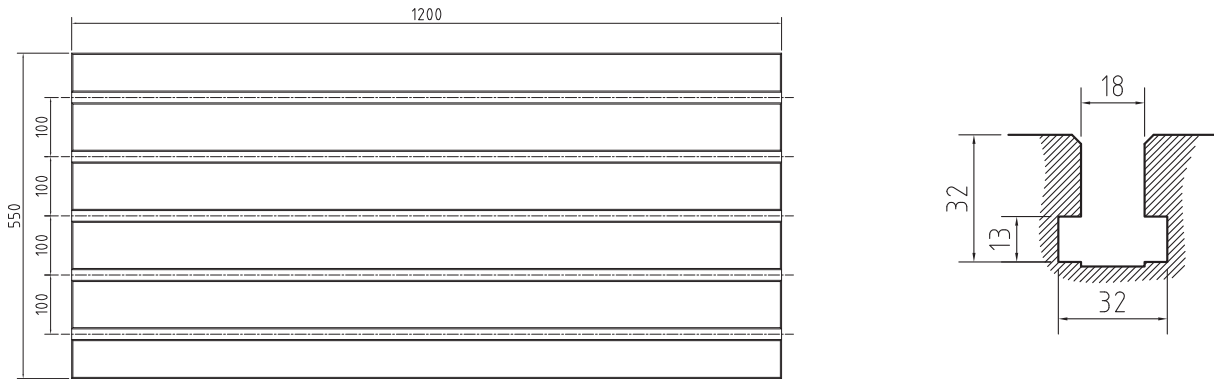

Dimensions (V11L)

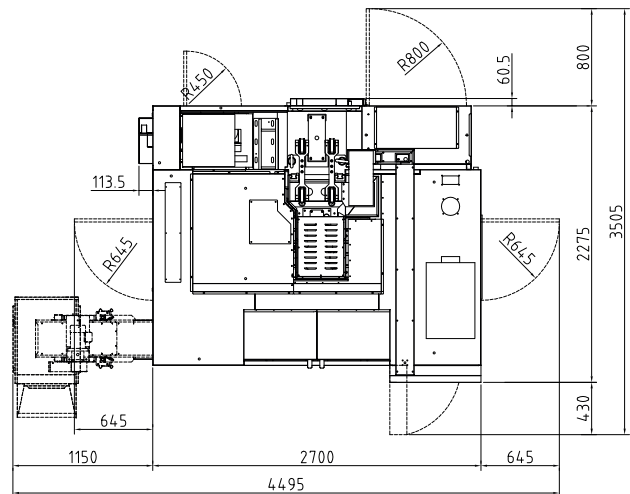
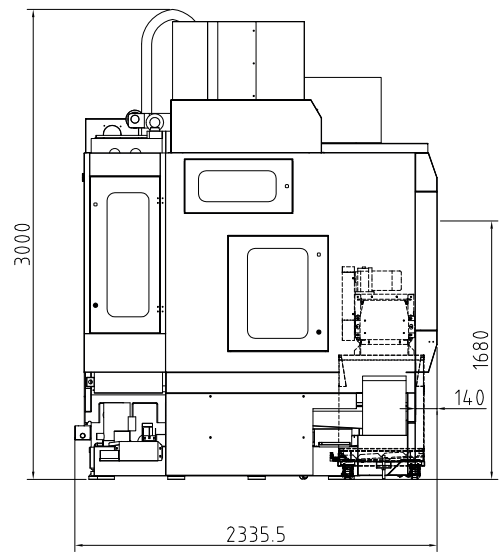
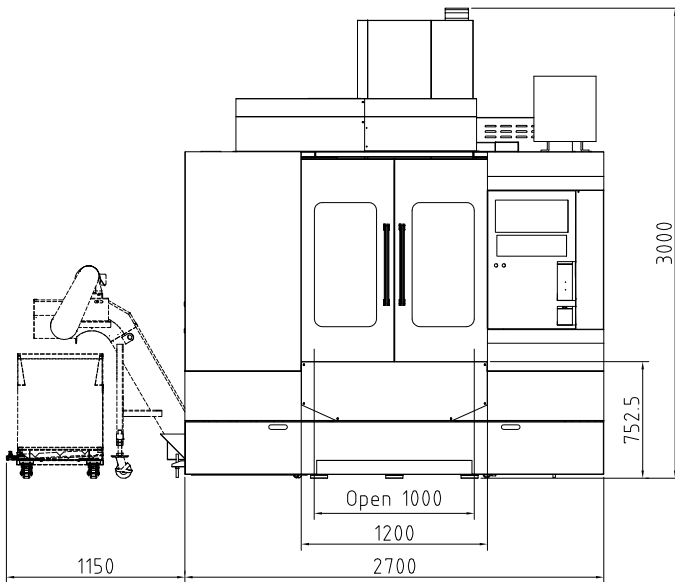

* The above specifications are subject to change without prior notice, no liability for mistakes. Machines may be shown with optional equipment.

Alpha Center V13L · V15L



- Cast iron is tempered for stress relief to ensure structural stability without deformation
- C3 class ballscrews ensures the highest accuracy and durability
- Pre-tension on all axis minimizes thermal distortion



V15L frame with Y axis four linear guideways

Technical Specifications		V13L	V15L
Table			
Table size	mm	1500 x 650	1700 x 700
T-slot (width x number x distance)	mm	18 x 5 x 100	18 x 6 x 100
Max. load	kg	1200	1500
Travel			
X / Y / Z Travel	mm	1300 / 650 / 600	1500 / 760 / 700
Spindle nose to table	mm	150 - 750	130 - 830
Spindle center to column	mm	697	802
Spindle			
Spindle taper	-	SK40/BT40/CAT40	
Spindle speed	rpm	10000	
Spindle motor power/torque	-	20/53kW; 126/250Nm(SIEMENS) 11/18.5kW; 52.5/118Nm(FANUC)	
Tool changer			
Number of tools	pcs	24	
Max. tool length	mm	300	
Max. tool diameter	mm	Φ78 / Φ125	
Max. tool weight	kg	8	
Feed			
Rapid feed X/Y/Z	m/min	36/36/24	24/24/24
Cutting speed	mm/min	1-12000	
Accuracy (VDI 3441 Full travel)			
Positioning accuracy	mm	0.010	
Positioning repeatability	mm	0.006	
Dimensions & Weight			
Dimensions	mm	4025x3090x3185	5180x2365x3170
Weight	kg	8000	10000

Standard configuration:

- ✓ Fully enclosed splash guard
- ✓ Belt drive spindle 10000 rpm
- ✓ 24 pockets arm tool changer
- ✓ Chain type chip conveyor
- ✓ Air-conditioned electrical cabinet
- ✓ Rigid tapping
- ✓ Ethernet, CF card and USB interface
- ✓ Automatic lubrication system
- ✓ Coolant system
- ✓ LED working lamp
- ✓ End of program light
- ✓ Electronic handwheel (MPG)
- ✓ Tool box
- ✓ Leveling bolts and blocks
- ✓ Coolant gun
- ✓ Air gun
- ✓ Air blast during cutting
- ✓ User Manual

Optional configuration:

- Belt drive spindle 6000 rpm BT50
- Belt drive spindle 8000 rpm BT50(Only available on V13L)
- Direct drive spindle 12000rpm
- Direct drive spindle 15000 rpm(Only available on SIEMENS and HEIDENHAIN)
- Spindle oil cooler
- CTS Coolant through spindle + ATS
- Oil skimmer
- Workpiece probe
- Tool probe
- 4th axis
- 4/5th axis

Worktable (V15L)

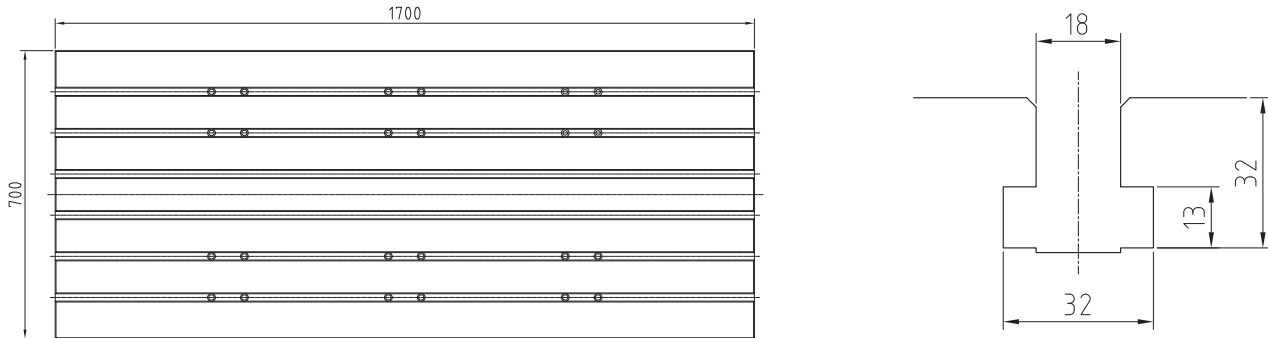

Dimensions (V15L)

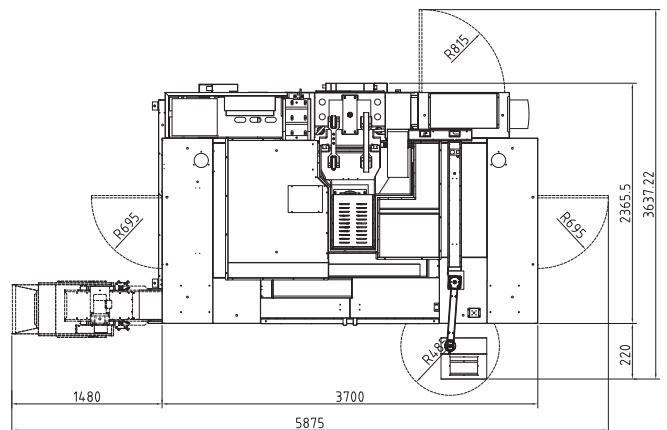
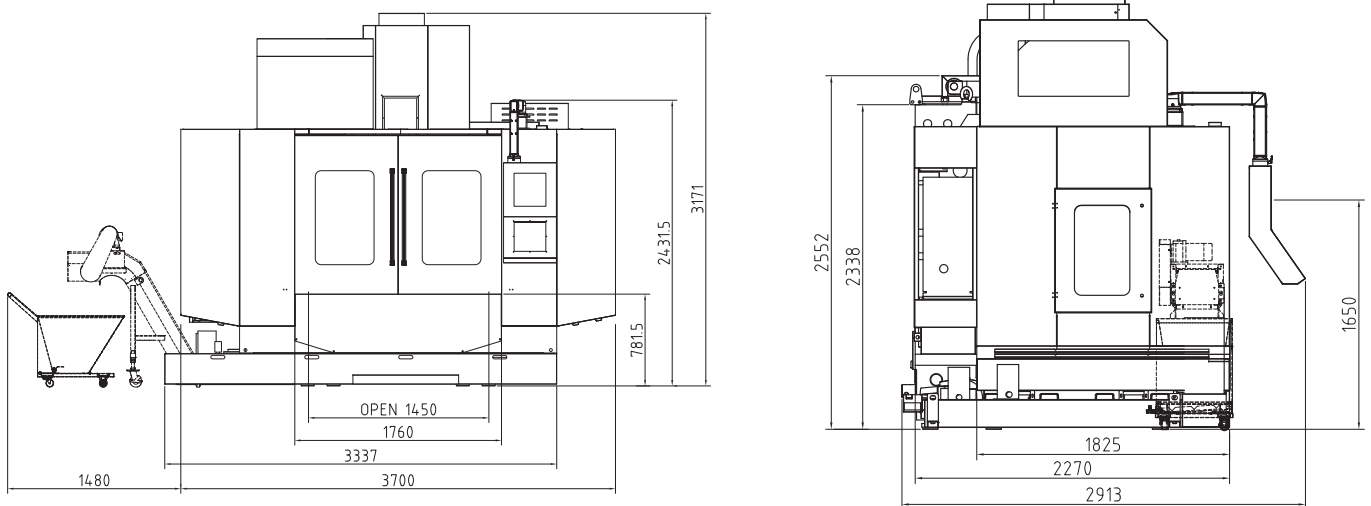

5th axis, different sizes

* The above specifications are subject to change without prior notice, no liability for mistakes. Machines may be shown with optional equipment.

Power Center V18



- Best choice for super heavy duty cutting with large workpiece
- X and Y axis with roller type linear guideways and Z axis with boxway guideways
- 50 taper spindle with belt drive 6000 rpm as standard, and optional with gearbox

- C3 class ballscrews ensures the highest accuracy and durability
- Pre-tension on all axis minimizes thermal distortion



Technical Specifications	Power Center V18	
Table		
Table size	mm	2000 x 900
T-slot (width x number x distance)	mm	22 x 5 x 165
Max. load	kg	2000
Travel		
X / Y / Z Travel	mm	1800 / 900 / 800
Spindle nose to table	mm	160 - 960
Spindle center to column	mm	950
Spindle		
Spindle taper	-	SK 50 / BT 50 / CAT 50
Spindle motor power/torque	-	17/42kW; 183/400Nm (SIEMENS) 15/20.3kW; 143/259Nm (FANUC)
Spindle speed	rpm	6000
Feed		
Rapid speed X/Y/Z	m/min	20/20/15
Cutting speed	mm/min	1-12000
Tool changer		
Number of tools	pcs	24
Max. tool length	mm	400
Max. tool diameter	mm	Φ125 / Φ245
Max. tool weight	kg	15
Accuracy (VDI 3441 Full travel)		
Positioning accuracy	mm	0.016
Positioning repeatability	mm	0.010
Dimensions & Weight		
Dimensions	mm	5722x3335x3440
Weight	kg	17500

Standard configuration

- ✓ Fully enclosed splash guard
- ✓ Belt drive spindle 6000 rpm
- ✓ 24 pockets arm tool changer
- ✓ Two screw type and one chain type chip conveyor
- ✓ Spindle oil cooler
- ✓ Air-conditioned electrical cabinet
- ✓ Rigid tapping
- ✓ Ethernet, CF card and USB interface
- ✓ Automatic lubrication system
- ✓ Coolant system
- ✓ LED working lamp
- ✓ End of program light
- ✓ Electronic handwheel (MPG)
- ✓ Tool box
- ✓ Leveling bolts and blocks
- ✓ Coolant gun
- ✓ Air gun
- ✓ Air blast during cutting
- ✓ User Manual

Optional configuration

- Gear box spindle 6000 rpm
- 32 pockets chain type tool changer
- CTS Coolant through spindle + ATS
- Oil skimmer
- Workpiece probe
- Tool probe
- 4th axis
- 4/5th axis
- Extra 200GB SSD program memory (Only available on SIEMENS Control)

Worktable

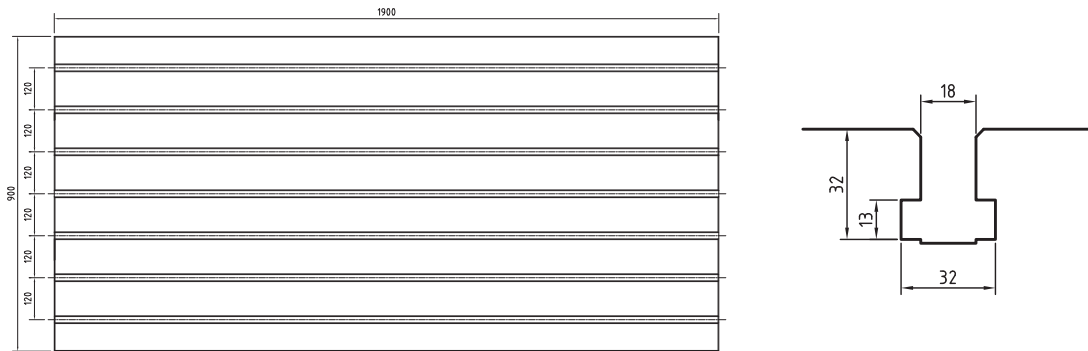

Dimensions

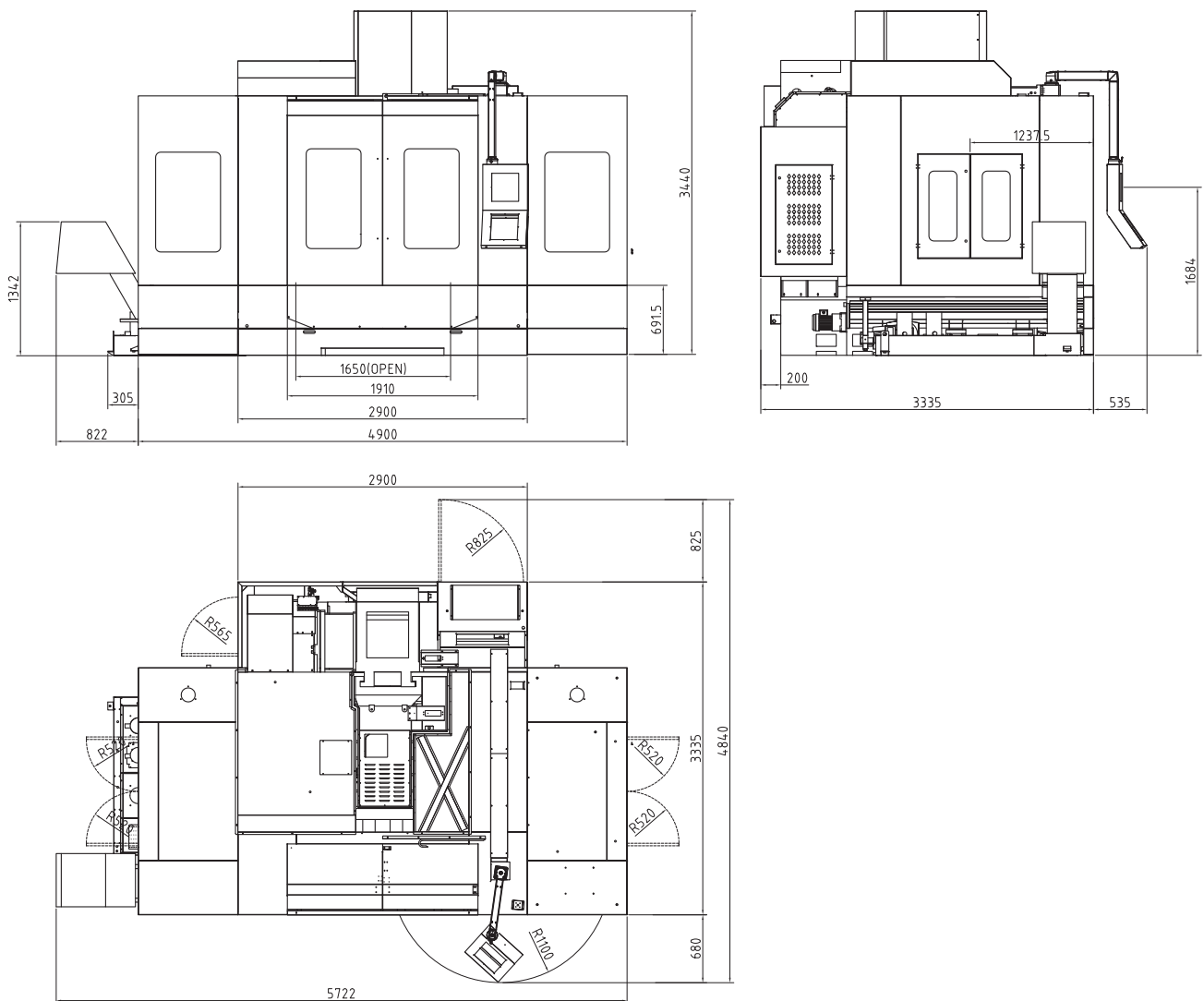

* The above specifications are subject to change without prior notice, no liability for mistakes. Machines may be shown with optional equipment.

GT428-5X



Technical Specifications		GT428-5X		
Table				
Table size	mm	4000x2400		
T-slot (width x number x distance)	mm	28x11x200		
Max. load	kg	12000		
Travel				
X/Y/Z Travel	mm	4200/3300/1200		
Spindle nose to table	mm	80 - 1280	-40 - 1160	85-1285
90° spindle center line to table	mm	363-1563	310-1510	452.5-1652.5
Distance between columns	mm	2800		
A/C Head		Model L	Model XL	Model S
A/C Travel	-	±115° / 360°	±110° / ±250°	±108° / ±270°
A/C Clamping torque	Nm	10500/5400	8000/8000	2000/3000
Spindle				
Spindle taper	-	HSK A100	HSK A100	HSK A100
Motor power	kW	50/61	40/47	40/50
Motor torque	Nm	160/193	248/293	103/129
Spindle speed	rpm	15000	12000	15000
Feed				
Rapid feed X/Y/Z	m/min	12/15/20		
Cutting speed	mm/min	1-12000		
A(B)/C Max. speed	rpm	50		
Tool changer				
Number of tools	pcs	60		
Max. tool length	mm	400		
Max. tool diameter	mm	Φ125 / Φ250		
Max. tool weight	kg	16		
Accuracy (VDI 3441 Full travel)				
Positioning accuracy	mm	0.020/0.015/0.010 (X/Y/Z) 6/8 arc-sec (A/C)		
Repeatability accuracy	mm	0.015/0.010/0.006 (X/Y/Z) 3/4 arc-sec (A/C)		
Dimensions & Weight				
Dimensions	mm	11980x6751x6320		
Weight	kg	52000		

Standard configuration

- ✓ Direct drive A/C head
- ✓ Full enclosed splash guard
- ✓ Model L AC head, built-in spindle HSK A100 15000 rpm
- ✓ 60 pockets chain type tool changer
- ✓ Chip conveyor (two screw type and one chain type)
- ✓ Air-conditioned electrical cabinet
- ✓ High precision spindle water cooler
- ✓ Linear scales on X/Y/Z axis
- ✓ Rotary encoder on A/C axis
- ✓ Rigid tapping
- ✓ Ethernet, CF card and USB interface
- ✓ Automatic lubrication system
- ✓ Coolant system
- ✓ Air blast during cutting
- ✓ LED working lamp
- ✓ End of program light
- ✓ Electronic handwheel (MPG)
- ✓ Tool box
- ✓ Leveling bolts and blocks
- ✓ Coolant gun
- ✓ Air gun
- ✓ User Manual

Optional configuration

- Model XL AC head, built-in spindle HSK A100 12000 rpm
- Model S AC head, built-in spindle HSK A100 15000 rpm
- CTS Coolant through spindle + ATS
- Oil skimmer
- Workpiece probe
- Tool probe
- Dynamic Collision Monitoring (DCM)
- Kinematics
- Extra 200GB SSD program memory

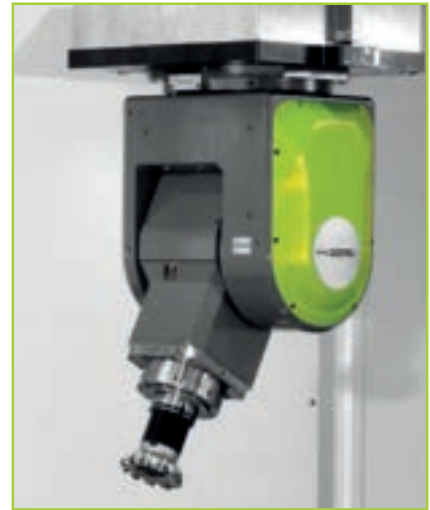

- Torque motor direct drive double arm head
- Heidenhain linear scales on X, Y, Z axis
- 4 linear guideways on Z axis ensure high rigidity and high accuracy
- Z axis designed with dual drive technology two ballscrews for high dynamic machining
- 3 linear guideways on Y axis
- Extra wide machine column and base design ensures the high rigidity for heavy duty cutting

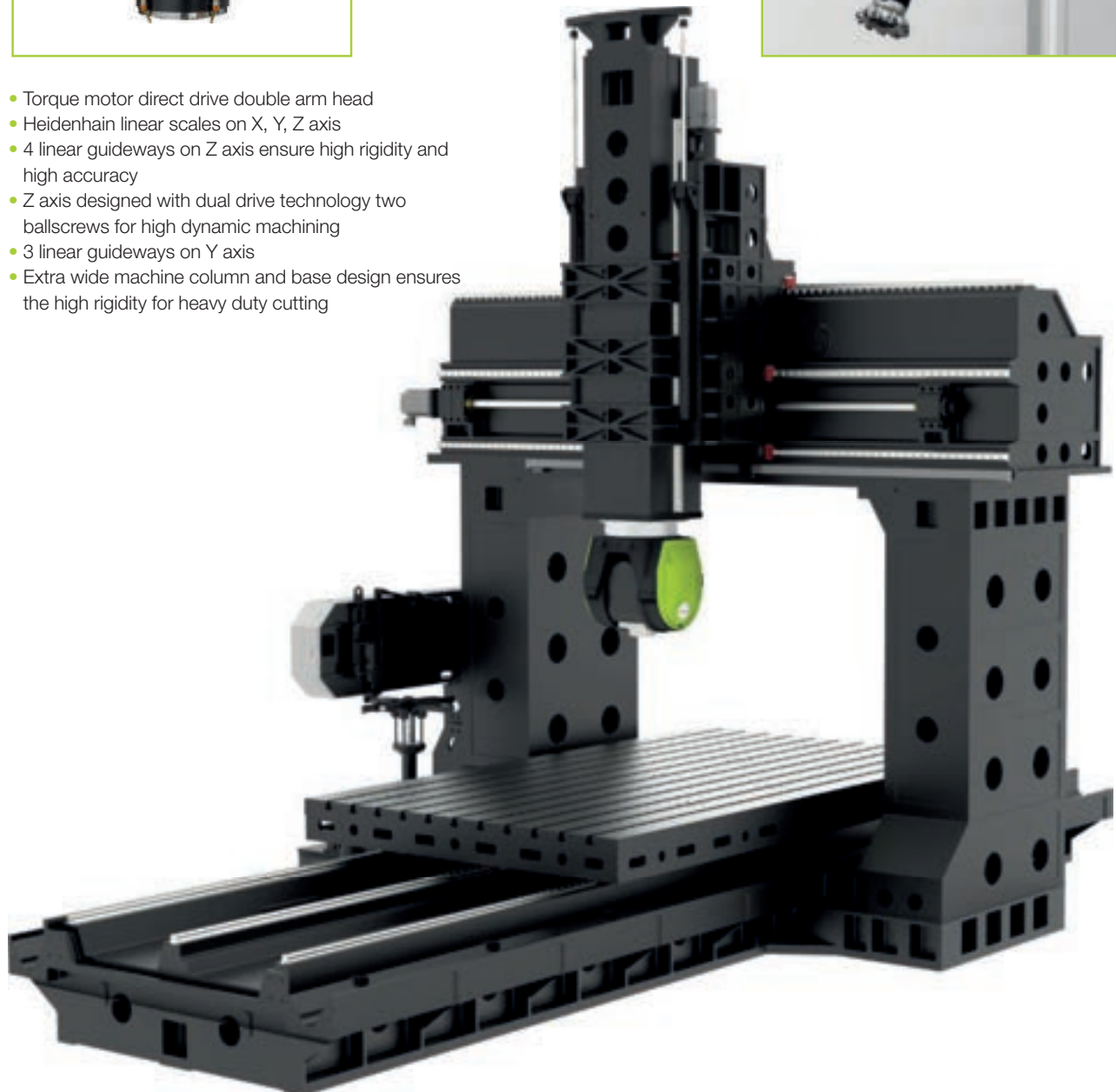

GT428-5XG

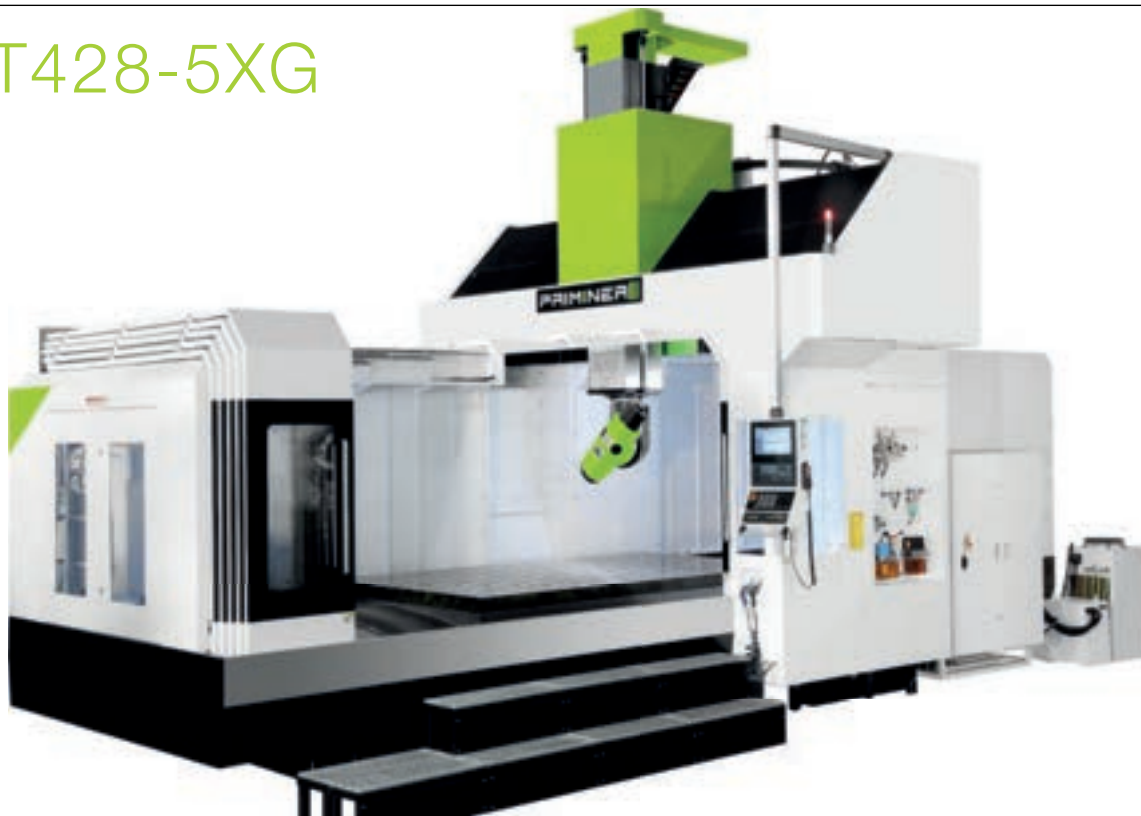

Technical Specifications		GT428-5XG
Table		
Table size	mm	4000x2400
T-slot (width x number x distance)	mm	28x11x200
Max. load	kg	12000
Travel		
X/Y/Z Travel	mm	4200/3300/1200
Spindle nose to table	mm	250-1450
90°spindle center line to table	mm	475-1675
Distance between columns	mm	2800
A/C Head		
A/C Travel	-	±135°/±180°
A/C Clamping torque	kg	10000
Spindle		
Spindle taper	-	BT50
Motor power	kW	30/62
Motor torque	Nm	1028/1776
Spindle speed	rpm	3000/4000 (S1/S6)
Feed		
Rapid feed X/Y/Z	m/min	12/15/20
Cutting speed	mm/min	1-12000
Tool changer		
Number of tools	pcs	60
Max. tool length	mm	400
Max. tool diameter	mm	Φ125 / Φ250
Max. tool weight	kg	16
Accuracy(VDI 3441 Full travel)		
Positioning accuracy	mm	0.020/0.015/0.010 (X/Y/Z)
Repeatability accuracy	mm	0.015/0.010/0.006 (X/Y/Z)
Dimensions & Weight		
Dimensions	mm	11980x6751x6320
Weight	kg	52000

Standard configuration

- ✓ Siemens 828D Control PPU290 (3+2)
- ✓ Orthogonal Auto-Indexing Milling Head
- ✓ Full enclosed splash guard
- ✓ Chip conveyor (two screw type and one chain type)
- ✓ BT50 chain type tool changer 60 pockets
- ✓ Spindle motor with high precision water cooler
- ✓ Spindle and gearbox oil cooler
- ✓ Air-conditioned electrical cabinet
- ✓ Linear scales on X/Y/Z axis
- ✓ Rigid tapping
- ✓ Ethernet, CF card and USB interface
- ✓ Automatic lubrication system
- ✓ Coolant system
- ✓ Air blast during cutting
- ✓ LED working lamp
- ✓ End of program light
- ✓ Electronic handwheel (MPG)
- ✓ Tool box
- ✓ Leveling bolts and blocks
- ✓ Coolant gun
- ✓ Air gun
- ✓ User Manual

Optional configuration

- CTS Coolant through spindle + ATS
- Oil skimmer
- Workpiece probe
- Tool probe
- Extra 200GB SSD program memory



- Orthogonal Auto-Indexing Milling Head
- Heidenhain linear scales on X, Y, Z axis
- 4 linear guideways on Z axis ensure high rigidity and high accuracy
- Z axis designed with dual drive technology two ballscrews for high dynamic machining
- 3 linear guideways on Y axis
- Extra wide machine column and base design ensures the high rigidity for heavy duty cutting

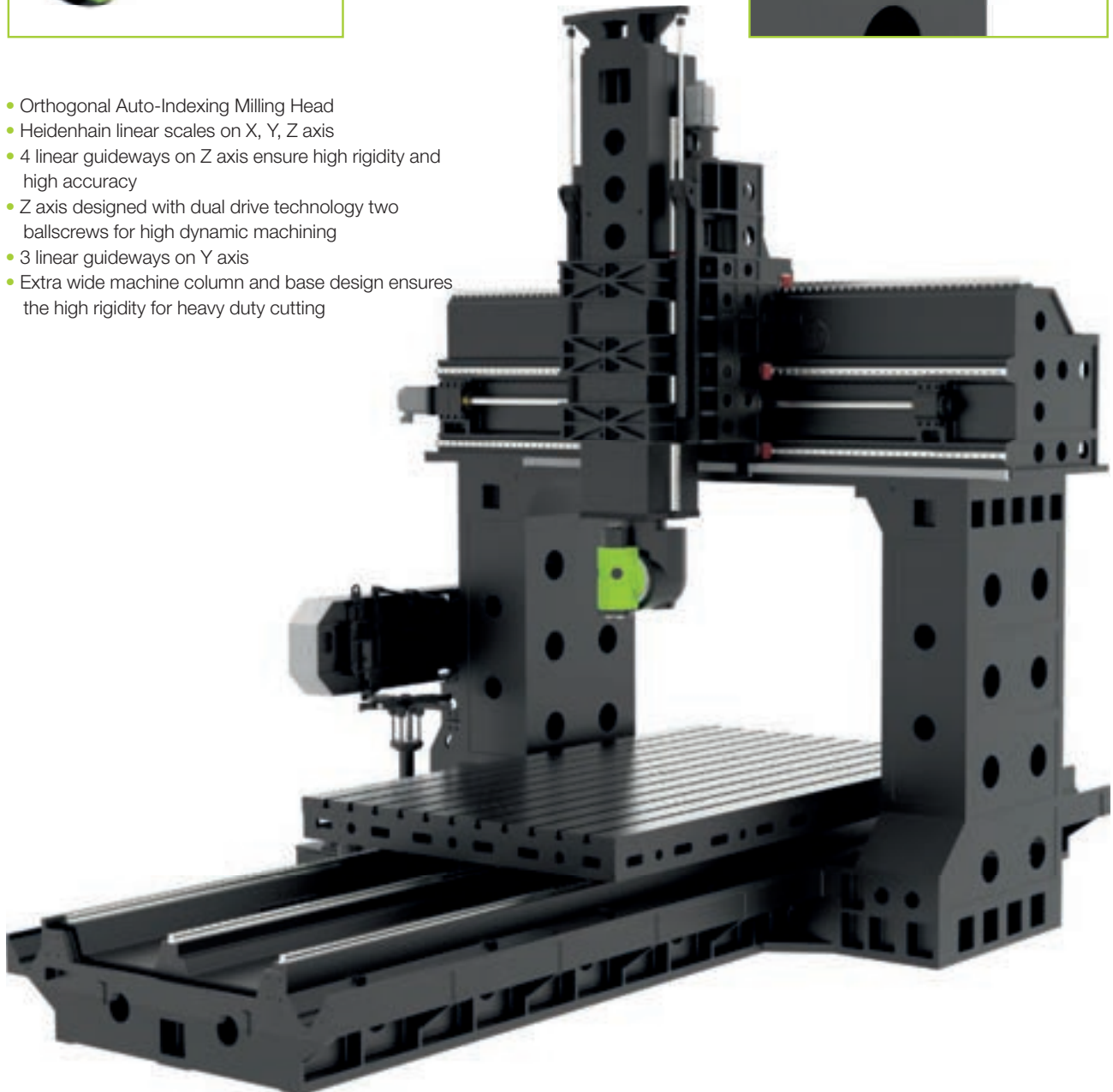

Double Column Center V1613HS



- Cast iron is tempered for stress relief to ensure structural stability without deformation
- C3 class ballscrews ensures the highest accuracy and durability
- Pre-tension on all axes minimizes thermal distortion
- Roller type linear guideway, which offers super high rigidity and loading capacity

Standard configuration:

- ✓ Fully enclosed splash guard
- ✓ Air-conditioned electrical cabinet
- ✓ Rigid tapping
- ✓ Chip conveyor (two screw type and one chain type)
- ✓ Ethernet, CF card and USB interface
- ✓ Automatic lubrication system
- ✓ Coolant system
- ✓ Spindle oil cooler
- ✓ LED working lamp
- ✓ End of program light
- ✓ Electronic handwheel (MPG)
- ✓ Tool box
- ✓ Leveling bolts and blots
- ✓ Coolant gun
- ✓ Air gun
- ✓ User Manual

Optional configuration:

- Direct drive spindle 15000 rpm
- Built-in spindle 20000 rpm, HSK A63
- 32 pockets arm tool changer
- CTS coolant through spindle +ATS
- Linear scales
- Oil skimmer

Technical Specifications		V1613HS
Table		
Table size	mm	1700 x 1200
T-slot (width x number x distance)	mm	18 x 7 x 150
Max. load	kg	3000
Travel		
X/Y/Z Travel	mm	1600 / 1300 / 600
Spindle nose to table	mm	200 - 800
Distance between columns	mm	1380
Spindle		
Spindle taper	-	SK40 / BT40 / CAT40
Spindle motor power/torque	-	9/22kW; 63/135Nm(SIEMENS) 11/18.5kW; 52.5/118Nm(FANUC)
Spindle speed	rpm	12000
Spindle transmission	-	direct drive
Feed		
Rapid feed X/Y/Z	m/min	20
Cutting speed	mm/min	1-12000

Technical Specifications		V1613HS
Tool changer		
Number of tools	pcs	32 (option)
Max. tool length	mm	300
Max. tool diameter	mm	Φ78 / Φ125
Max. tool weight	kg	8
Accuracy (VDI 3441 Full travel)		
Positioning accuracy (without linear scales)	mm	0.012
Positioning repeatability (without linear scales)	mm	0.010
Positioning accuracy (with linear scales)	mm	0.010
Positioning repeatability (with linear scales)	mm	0.008
Dimensions & Weight		
Dimensions	mm	4890x4110x3650
Weight	kg	16000

Worktable

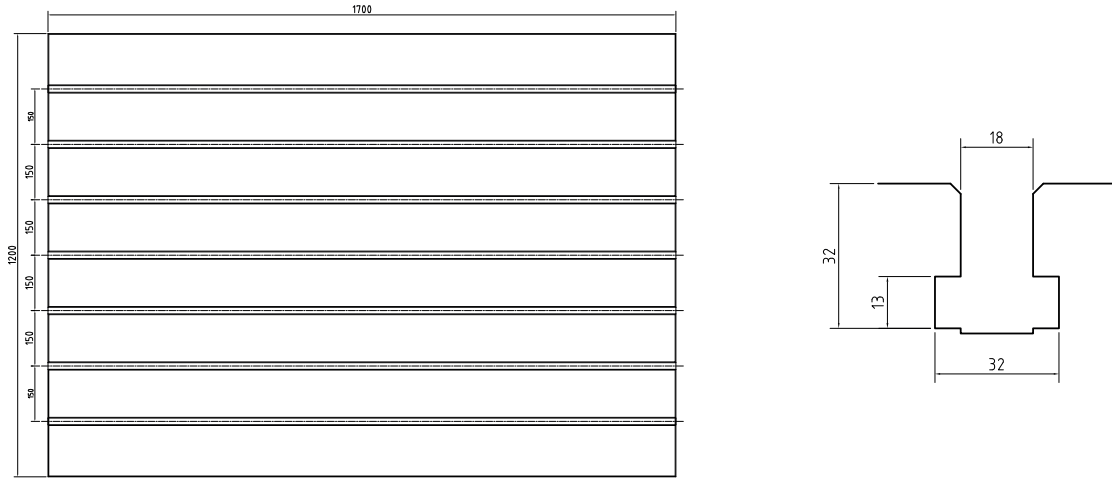

Dimensions (V1613HS)

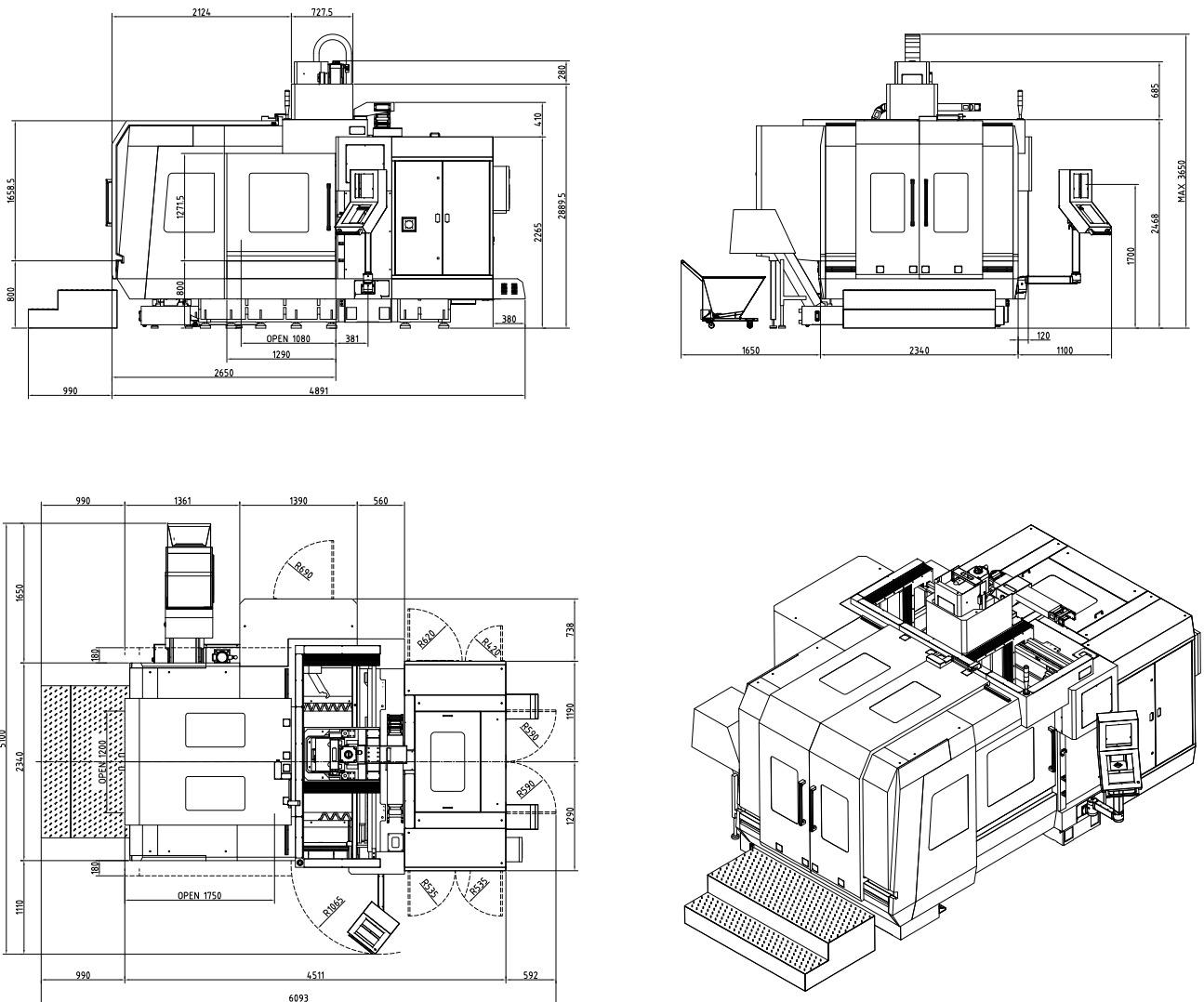

* The above specifications are subject to change without prior notice, no liability for mistakes. Machines may be shown with optional equipment.

Double Column Center V2015 · V3320 · V4028

- Extra wide column to increase to connection surface with the crossbeam to avoid vibration during cutting.
- Roller type linear guideway, which offers super high rigidity and loading capacity
- Hydraulic balancing system on Z axis



Technical Specifications		V2015	V3320	V4028
Table				
Table size	mm	2100×1200	3300×1700	4000×2400
T-slot (width x number x distance)	mm	22×7×150	22×9×180	28×11×200
Max. load	kg	4000	10000	12000
Travel				
X/Y/Z Travel	mm	2000/1500/800	3300/2700/1000	4200/3300/1200
Spindle nose to table	mm	170-970	200-1200	300-1500
Distance between columns	mm	1500	2000	2800
Spindle				
Spindle speed	rpm	BT50, 6000 rpm		
Power/torque(SIEMENS)	kW / Nm	22/60 kW, 172/380 Nm		
Power/torque(FANUC)	kW / Nm	15/18.5 kW, 143/259 Nm	22/45 kW, 140/286 Nm	
Spindle speed(optional, only available on SIEMENS)	rpm	/	HSK A100, 12000 rpm	
Power/torque	kW / Nm	/	20/22.5 kW, 298/346 Nm	
Feed				
Rapid feed X/Y/Z	m/min	15/15/12	24/24/30	20
Cutting speed	mm/min	1-12000		
Accuracy (VDI3441 Full travel)				
Positioning accuracy (without linear scales)	mm	0.015	0.020/0.020/0.015(X/Y/Z)	0.0250/0.020/0.015(X/Y/Z)
Positioning repeatability (without linear scales)	mm	0.012	0.015/0.015/0.010(X/Y/Z)	0.020/0.015/0.010(X/Y/Z)
Positioning accuracy (with linear scales)	mm	0.015	0.015/0.015/0.010(X/Y/Z)	0.020/0.015/0.010(X/Y/Z)
Positioning repeatability (with linear scales)	mm	0.008	0.010/0.010/0.006(X/Y/Z)	0.015/0.010/0.006(X/Y/Z)
Dimensions & Weight				
Dimensions	mm	7090×4120×4250	10000×5700×5400	10500×6200×5850
Weight	kg	19000	30000	52000



Hydraulic balancing system in Z axis



Chip conveyor

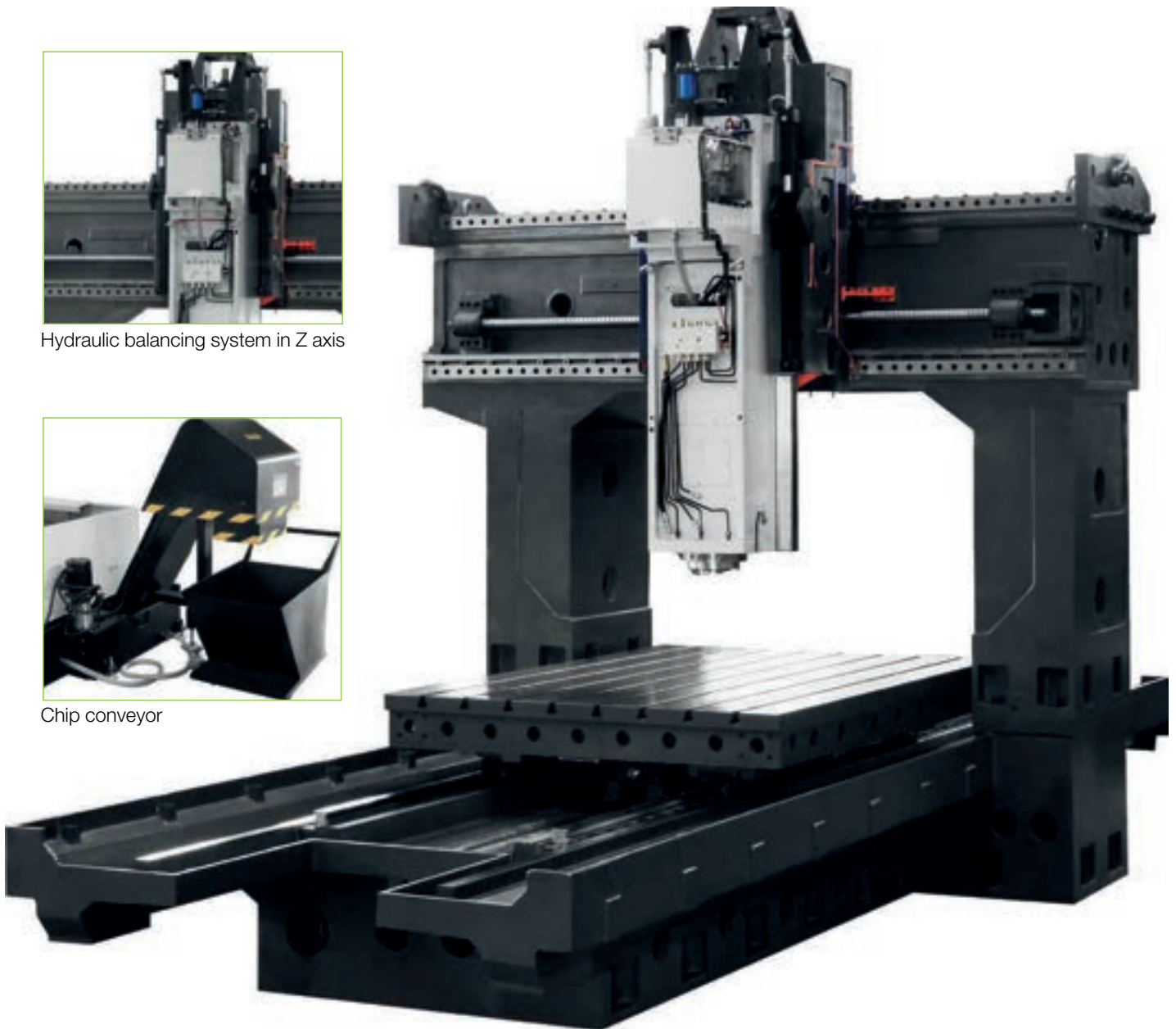

Standard configuration:

- ✓ Half enclosed splash guard
- ✓ Air-conditioned electrical cabinet
- ✓ Rigid tapping
- ✓ Chip conveyor (two screw type and one chain type)
- ✓ Ethernet, CF card and USB interface
- ✓ Automatic lubrication system
- ✓ Coolant system
- ✓ Spindle oil cooler
- ✓ LED working lamp
- ✓ End of program light
- ✓ Electronic handwheel (MPG)
- ✓ Tool box
- ✓ Leveling bolts and blots
- ✓ Coolant gun
- ✓ Air gun
- ✓ User Manual

Optional configuration:

- Built-in type spindle 12000RPM, HSK A100(V3320, V4028, only available on SIEMENS)
- 24 pockets arm tool changer (Only available on V2015)
- 40 pockets chain type tool changer
- CTS coolant through spindle + ATS
- Gearbox
- Linear scales(V3320, V4028)

* The above specifications are subject to change without prior notice, no liability for mistakes. Machines may be shown with optional equipment.

PRIMINER



**Le macchine utensili PRIMINER
sono distribuite in Italia da**



Con il progetto BEST SERVICE abbiamo
lanciato un servizio di assistenza che è uno
dei nostri più importanti punti di forza.

 WhatsApp Uff. Service
+39 338.631.5389

EMIL MACCHINE UTENSILI S.P.A.

Via Bulgaria, 24
40122 Modena, Italy

Tel.: **+39 059 311574**
Fax: **+39 059 454338**

info@emusrl.com
www.emilmacchineutensili.it



DISTRIBUTORE